



COMMERCIAL vehicle products





Company Profile

Delphi Diesel Aftermarket North America offers a comprehensive range of diesel repair parts, pumps, rotating electrics, electronic & safety products, thermal products, sensors, fuel additives, remanufactured injectors, test equipment and diagnostic tools to service on and off highway, marine, construction, agriculture and industrial applications.

In addition to our distribution network located across the United States and Canada, we support service part requirements of on and off road diesel engines and commercial vehicle manufacturers. Our customers in North America include many of the leading OE manufacturers such as AGCO, Caterpillar, Cummins, John Deere, Volvo and Mack Trucks.

We provide comprehensive services for:

- Technical support, warranty administration and training
- Customer branded packaging, inventory control, and distribution
- Order management using EDI
- Remanufactured products for fuel, electronics and hydraulic components in an ISO9001:2000 facility

Learn more about Delphi Diesel Aftermarket:

Email us @ ddana@delphi.com

Call us @ 800-521-4784

Visit <http://dieselaftermarket.delphi.com>



FEATURED PRODUCT INFORMATION

EGR	06
FEED PUMP	07
REMANUFACTURED ELECTRONIC UNIT INJECTORS	10
REMANUFACTURED ENGINE CONTROL & POWERTRAIN CONTROL MODULES	04
SENSORS.....	14
SMART REMOTE ACTUATOR (SRA).....	68

VIN CODE IDENTIFICATION 08

PRODUCTS BY OEM

CUMMINS	09
DETROIT DIESEL.....	11
DODGE	15
FORD.....	18
GM-LIGHT DUTY.....	26
GM-MEDIUM DUTY.....	36
MACK.....	57
MERCEDES-BENZ.....	61
NAVISTAR.....	62
VOLVO	69

CROSS REFERENCES

OEM TO DELPHI	70
DELPHI TO OEM	76
EUI CROSS REFERENCE FOR DETROIT DIESEL AND CUMMINS INJECTORS	82
CORE CRITERIA AND WARRANTY POLICY.....	84
RADIATOR DIMENSIONS	87



REMANUFACTURED ENGINE CONTROL & POWERTRAIN CONTROL MODULES

EC Series Part Numbers

Want to capitalize on a growing, virtually untapped segment of the aftermarket? With Delphi's expanding lineup of Remanufactured Engine Control Modules (ECMs) and Powertrain Control Modules (PCMs), you can offer your customers OE-replacement products, coupled with the support to service today's advancing vehicle engine management systems.



PROGRAM HIGHLIGHTS

- Original Equipment Service (OES)-certified replacement part functionality and content.
- Remanufactured with the latest automaker calibrations installed on programmed units.

THE DELPHI ADVANTAGE

- 100% OES-specified, providing comparable quality and performance as modules supplied by GM.
- Remanufactured using Delphi's knowledge of OEM protocols - not reverse engineered like many other electronic - aftermarket lines.
- Designed to fully integrate with vehicle electronic-and fuel-delivery systems, alleviating potential installation problems and, consequently, customer comebacks.
- Available sales team training, promotional launch support and product seminars to assist with product pull-through from technicians.
- Works in tandem with Delphi's Universal Reprogramming Tool, allowing you to tap into the growing ECM/PCM reflash and program update markets.

DID YOU KNOW?

- Early ECM/PCM modules stored content on replaceable, programmable chips. With OBD II-compliant units, the information is stored on internal, non-removable "flash drives," which are similar to the technology used on digital cameras. As a result, the "digital content" on today's ECMs/PCMs can be easily erased and the chip flashed with newer OEM information.
- Current out-of-warranty ECM/PCM failure rates are about 2% a year, which is about equal to that of compressors, ignition coils and wheel bearings. Delphi estimates this represents an annual market opportunity of \$513 million at the retail level.
- The number of ECMs/PCMs that require "programming updates" is increasing. These OEM-issued updates correct drivability or vehicle performance problems. As a result, some shops are now incorporating routine ECM/PCM checks into their vehicle maintenance services. Shops are charging \$80-\$110, on average, for as-required updates, generating increased customer satisfaction and a significant new revenue source.

FEATURES

BENEFITS

Remanufactured to OE Specifications; replaced parts are the latest OE design	<ul style="list-style-type: none"> - Improves vehicle performance - Reduces reflash and installation problems, which speeds up repair times and bay turns
100% full-functional testing on every unit to meet OES requirements	<ul style="list-style-type: none"> - Verifies unit functionality and capabilities against the total range of automaker operating standards
Internal workmanship, including solder quality and wire routing, is remanufactured to OES standards	<ul style="list-style-type: none"> - Ensures product reliability and quality
Reassembly process includes inspection of cover seals and leak checks	<ul style="list-style-type: none"> - Guards against possible environmental contamination, as well as corrosion-based malfunctions



DELPHI VS. THE COMPETITION

Delphi has compared the out-of-the box quality of its remanufactured ECMs/PCMs against that of other aftermarket brands. The "competitive teardown," as the study is known, showed the following:

COMPETITOR MODULES	POSSIBLE IMPACT	DELPHI DIFFERENCE
Corrosion on connectors	Intermittent input and output problems	All connector elements are cleaned, performance-tested and replaced, if necessary, before leaving the factory
Inside board screws loose and screws mismatched	Vibration-induced failures	Remanufacturing process includes reassembling to OE specifications
Module outer-case seals improperly seated and fasteners are loose	Component failure due to moisture intrusion	All seals examined, where applicable; bad or damaged seals are replaced and reassembled to OE specifications
Partially or intermittently functional modules	Poor drivability and "check engine" lights	Thorough testing, using OES specification-based routines, are programmed directly into <u>all</u> modules to find defects
Inability to reflash units	Vehicle won't operate	Reflash capability confirmed prior to units leaving the factory



EXHAUST GAS RECIRCULATION (EGR) VALVES

EG Series Part Numbers

Exhaust gas recirculation (EGR) valves deliver finely metered amounts of exhaust to the engine intake to help reduce NOx emissions.



PROGRAM HIGHLIGHTS

- 100% OE line
- No shims required to get proper fit
- Gaskets included
- Utilizes high-temperature diaphragms for long-term durability
- No clocking required
- OE fit, not a universal consolidated line
- Saves time and labor for technicians, which means more bay turns for repair shops

THE DELPHI ADVANTAGE

- Delphi EGR valves are available in port, back pressure, and linear configurations to allow coverage of many engine applications.
- Precision machining of valves and seats helps maintain long-term stability of all Delphi EGR valves.
- High-temperature materials are used for internal windings of all Delphi EGR valves, providing high exhaust temperature performance.
- All Delphi EGR valves offer rugged environmental protection for corrosion resistance.
- Delphi EGR valves perform under all engine temperature ranges.

FEATURES

FEATURES	BENEFITS
Precision manufacturing	— Provides accurate exhaust gas flow control
Rugged environmental protection	— Helps resist corrosion — Provides good performance under all engine temperature operating ranges
100% OE line with gaskets and exact fit	— Saves time and labor

DID YOU KNOW?

- EGR valves decrease oxides of nitrogen (NOx) exhaust emissions. NOx is a major contributor to smog.
- Inoperative EGR valves increase emissions and degrade fuel economy.
- Malfunctioning linear EGR valves can trigger the "Service Engine Soon" light.



FEED PUMPS

HFP Series Part Numbers

Delphi offers a wide range of mechanical and electrical feed pumps that incorporate the latest technological advancements.



PROGRAM HIGHLIGHTS

- With over 600 different feed pumps, Delphi covers a wide range of industrial, agricultural and on-highway applications - including: Ford Trucks, Dodge Trucks, Chevrolet and GM Trucks, Case New Holland, and numerous John Deere applications, among others.
- Delphi feed pumps are used in light and medium duty diesel and gasoline engine fuel systems - including Cummins 4B and 6B series, Navistar DT444E, DT466E and DTA530 engines, and Perkins engines.
- Delphi also offers fuel strainers for GM medium duty truck applications including - Chevrolet and GMC Kodiak, LC Forward, Topkick and FC Chassis V8, 6.0L, 7.0L, 7.4L and 8.1L engines for additional service opportunities.

THE DELPHI ADVANTAGE

- Delphi uses its 70 years of fuel delivery system expertise to offer you mechanical and electric fuel pumps that incorporate the latest technological advancements which match or even exceed OE performance.
- Delphi mechanical fuel pumps are available for most popular light duty vehicles and truck engines. Many of these pumps were original equipment; others are built to meet or exceed OE requirements.
- Warranty available nationwide through our Authorized

DID YOU KNOW?

- In the diesel industry feed pump, supply pump, lift pump and fuel pump are terms for the same part. It's the low pressure pump that pulls or pushes fuel from the tank through the filter to the high pressure injection pump.
- Electric fuel pumps are designed to prevent fuel from draining back to the tank once the engine has been shut down. This feature allows the fuel system to maintain residual pressure for quick restarts.

FEATURES

FEATURES	BENEFITS
Built to OE specifications	— Ensure highest quality
Feed pumps are exact fit original equipment replacement	— Allows easy installation
Consistent pressure at all temperatures	— Quick start-ups
All pumps are 100% functionally tested for minimum flow, maximum current load, relief valve opening pressure and check valve operation	— Improved pump reliability

BENEFITS

VIN CODE IDENTIFICATION

Model Year Code

Code de année modèle

Código de ano modelo

2	2002	R	1994	G	1986
1	2001	P	1993	F	1985
Y	2000	N	1992	E	1984
X	1999	M	1991	D	1983
W	1998	L	1990	C	1982
V	1997	K	1989	B	1981
T	1996	J	1988	A	1980
S	1995	H	1987		

Eighth Digit = Engine Code Letter
 Huitième chiffre = Lettre de code moteur
 Octavo dígito = Letra del código del motor

VIN number

1G2WJ54D7PF211211

Tenth Digit = Model Year
 Dixième chiffre = Année modèle
 Décimo dígito = Ano modelo



REMANUFACTURED ELECTRONIC UNIT INJECTORS

Year	Model/Engine	Description	Part Number
M11	280E	EX637557*
	330	EX631753*
	330E	EX637557*
	ISM335	EX631756*
	N/A	EX631758*
M11 ESP II	350E	EX637557*
	370E	EX637557*
	400E	EX637557*
N14		EX631766*
	310E	EX631761*
	310P	EX637560*
	330P	EX637560*
	350E	EX632542*
	350ESP	EX637560*
	370E	EX631761*
	410E	EX637560*
	425E	EX631763*
	430E	EX632542*
	435E	EX631760*
	460E	EX632542*
	500E	EX631760*
	525E	EX631763*
	525CE	EX631764*
N14A	14E	EX631767*

FEED PUMPS

4B, 4BT 3.9L	w/Diaphragm Type	HFP274
4BT 3.9L	w/Piston Type	HFP702
6B, 6BT 5.9L	w/Diaphragm Type	HFP274
6B, 6BT Series 5.9L	w/Piston Type	HFP701
6B, 6BT Series 5.9L	w/Piston Type; (Primer button on bottom)	HFP700
6C, 6CT Series 8.3L	HFP700



CUMMINS

* For core criteria information, please see page 84.



REMANUFACTURED ELECTRONIC UNIT INJECTORS

EX Series Part Numbers

Remanufactured Cummins Celect Electronic Injector

PROGRAM HIGHLIGHTS

- Remanufactured in our ISO 9001:2000 certified facility
- Cross-reference to 47 Cummins Part Listing (CPL)
- 60% coverage for M11 - N14 engine range

PRODUCT HIGHLIGHTS

- Every remanufactured injector is functionally tested for:
 - » Fuel Delivery
 - » Fuel Injection Pressure
 - » Timing

THE DELPHI ADVANTAGE

- Replacement of critical components
- 100% replacement of nozzle, NOP spring, and spring seat
- 2 year warranty or 125,000 miles on highway or 3,600 hours off highway
- Warranty available nationwide through our Authorized Service Distributor Network

DID YOU KNOW?

- Reducing diesel emission levels is critical in today's diesel engines. Delphi is leading this technology revolution with its advanced fuel injection systems.
- Delphi functionally tests 100% of its remanufactured products to ensure the highest quality.
- Delphi also offers a wide array of additional Electronic Unit Injectors (EUI).

Cummins is a trademark of Cummins, Inc



FEATURES

BENEFITS

100% nozzle, NOP spring and spring seat replacement	– Improved performance and durability
100% Surface lapping of critical components	– Ensures pressure sealing of sub-assemblies
New wiring harness	– No wire shorts
100% O-ring replacement	– Proper sealing



DETROIT DIESEL

OIL COOLERS	12
REMANUFACTURED ELECTRONIC UNIT INJECTORS	12
O-RING KIT.....	13



Electronic Unit Injector



Year Model/Engine Description Part Number

OIL COOLERS †

82 Series	HAC101
71 Series	HAC102
71 Series	HAC103
71 Series	HAC104
149 Series	HAC105
71 Series	HAC106
71 Series	HAC107
71 Series	HAC108
92 Series	HAC109
71 Series	HAC110
71 Series	HAC111
71 Series	HAC112
82 Series	HAC113
53 Series	HAC114
60 Series	HAC115
71 Series	HAC116
60 Series	HAC117
60 Series	HAC118
60 Series	HAC119
Multiple	HAC120
Multiple	HAC121
Multiple	HAC122
Multiple	HAC123
Multiple	HAC124
Multiple	HAC125

REMANUFACTURED ELECTRONIC UNIT INJECTORS

Series 50		
8.5L Series 50	EX635550*
8.5L Series 50	EX635575*
8.5L Series 50	EX635600*
8.5L Series 50	EX636347*
8.5L Series 50	EX636980*
8.5L Series 50	EX636981*
Series 60		
12.7L Series 60	EX634785*
12.7L Series 60	EX634795*
11.1L Series 60	EX634870*
11.1L Series 60	EX634935*
11,1L,12.7L Series 60	EX634940*
12.7L Series 60	EX634945*
11.1L Series 60	EX634970*
12.7L Series 60	EX634970*
12.7L Series 60	EX635575*

Year Model/Engine Description Part Number

REMANUFACTURED ELECTRONIC UNIT INJECTORS (cont.)

Series 60 (cont.)			
12.7L Series 60	EX635605*	
12.7L Series 60	EX635695*	
11.1L Series 60	EX634865*	
11.1L Series 60	EX635550*	
11.1L Series 60	EX635580*	
11.1L Series 60	EX635600*	
12.7L Series 60	EX636977*	
11.1L Series 60	EX636978*	
12.7L Series 60	EX637045*	
12.7L Series 60	EX637099*	
12.7L Series 60	EX637466*	
12.7L Series 60	EX637650*	
12.7L Series 60	EX635915*	
14.0L Series 60	EX637635*	

O-RING KIT

All Series 50/60	637001
------------------	-------	--------



Oil Cooler

† NOTE: The oil cooler line is a bulk quantity program available in 1/2 standard pack sizes. Please refer to the pricing sheet for pack sizes.

* For core criteria information, please see page 84.

* For core criteria information, please see page 84.



SENSORS

Sensors constantly monitor functions like airflow, engine knock, pressure, temperature, and position to provide feedback to the vehicle's control modules.

PROGRAM HIGHLIGHTS

- Delphi offers a wide variety of sensors that support popular categories
- Delphi-manufactured sensors meet or exceed original equipment requirements and testing

THE DELPHI ADVANTAGE

- Delphi sensors sold to the aftermarket channel are the same sensors sold to OE vehicle manufacturers
- Delphi is a worldwide supplier of a variety of sensors for engine management, body control, anti-lock braking, and traction control systems
- Delphi offers related engine management products for additional sales opportunities

DID YOU KNOW?

- Sensors report current conditions to the vehicle control modules, which then command injectors, ignition coils, solenoids and actuators to adjust to conditions.
- Failed sensors contribute to increased emissions and can contribute to reduced performance and fuel economy.



FEATURES	BENEFITS
Manifold absolute pressure sensors are insulated with silicone gel over the integrated circuit chip	- Protects the electronics from shock and vibration - Increases durability
Position sensors use hall effect or magneto resistive principles	- Provides electromagnetic interference protection against noise interference and other sensor outputs for the cleanest signal to control modules
Temperature sensors have a one-piece lead-frame design front sensing element tip to connector terminals	- Helps eliminate internal connections and failure points - Helps increase durability



DODGE

ALTERNATORS..... 16

ELECTRONIC CONTROL UNITS..... 16

FEED PUMPS 16

NOZZLES..... 17

SENSORS..... 17

VACUUM PUMPS & PODS 17

WATER PUMP..... 17

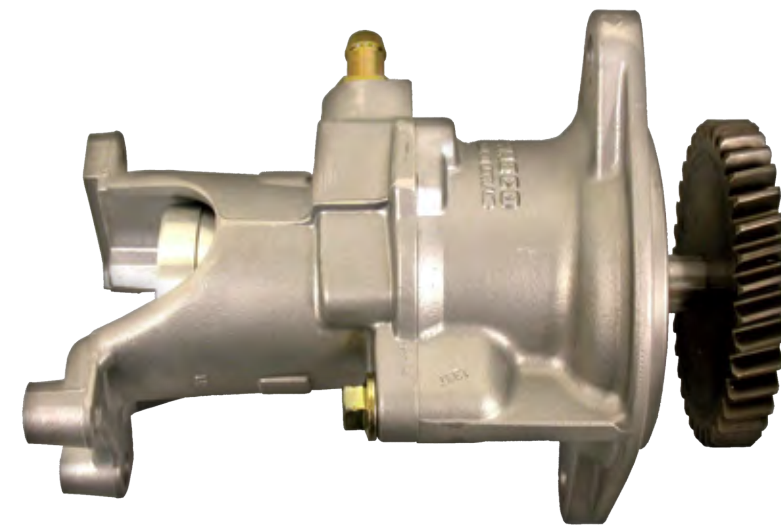

Vacuum Pump

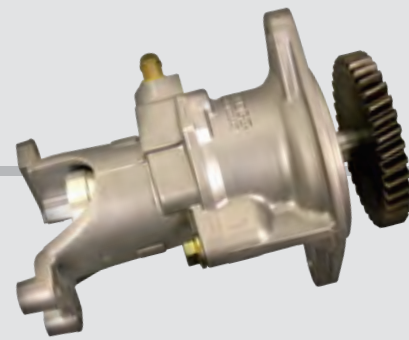

Year Model/Engine Description Part Number

ALTERNATORS & STARTERS

Alternators

1998-1990	5.9L, I6 Diesel	(120 amp.)	RM4011*
1989	5.9L, I6 Diesel	(120 amp. Chrysler style unit)	RM1601*
1989	5.9L, I6 Diesel	(120 amp. Denso style unit)	RM3979*

Starters

2000-1994	5.9L, I6 Diesel		SX3717*
1993-1988	5.9L, I6 Diesel		SX3691*

ELECTRONIC CONTROL UNITS

Ram Series Pickup

2003	I6, 5.9L, 359, C		EC10528-11B1*
2003	I6, 5.9L, 359, 6		EC10529-11B1*
2000	I6, 5.9L, 359, 6		EC10576-11B1*
2000	I6, 5.9L, 359, 6		EC10577-11B1*
2000	I6, 5.9L, 359, 6		EC10578-11B1*
2000	I6, 5.9L, 359, 6		EC10579-11B1*
1999	I6, 5.9L, 359, 6		EC10469-11B1*
1999	I6, 5.9L, 359, 6		EC10470-11B1*
1999	I6, 5.9L, 359, 6		EC10471-11B1*
1998	I6, 5.9L, 359, D		EC10568-11B1*
1998	I6, 5.9L, 359, D		EC10569-11B1*
1998	I6, 5.9L, 359, D		EC10570-11B1*
1998	I6, 5.9L, 359, D		EC10571-11B1*
1998	I6, 5.9L, 359, D		EC10536-11B1*
1998	I6, 5.9L, 359, D		EC10537-11B1*
1998	I6, 5.9L, 359, D		EC10538-11B1*
1998	I6, 5.9L, 359, D		EC10539-11B1*
1997	I6, 5.9L, 359, D		EC10246-11B1*
1997	I6, 5.9L, 359, D		EC10580-11B1*
1997	I6, 5.9L, 359, D		EC10581-11B1*
1997	I6, 5.9L, 359, D		EC10582-11B1*
1997	I6, 5.9L, 359, D		EC10583-11B1*
1996	I6, 5.9L, 359, C		EC10249-11B1*
1996	I6, 5.9L, 359, C		EC10588-11B1*
1996	I6, 5.9L, 359, C		EC10584-11B1*

FEED PUMPS

2004-2003	5.9L, I6 Diesel	Hose Kit	7135-297
2004-2003	5.9L, I6 Diesel	(12v Electric Type)	HFP943
2002-1998	5.9L, I6 Diesel	(12v Electric Type) NEW Improved Version of the HFP923	HFP953
2002-1998	5.9L, I6 Diesel	(12v Electric Type) Harness Kit INCLUDED	HFP923

Year Model/Engine Description Part Number

FEED PUMPS (cont.)

1997-1994	5.9L, I6 Diesel	(Piston Type)	HFP916
1993-1988	5.9L, I6 Diesel	(Diaphragm Type)	HFP274

NOZZLES

1997-1996	5.9L, I6 Diesel	w/Auto Transmission	6980084
1995-1994	5.9L, I6 Diesel	w/Manual Transmission	6980084
1993-1990	5.9L, I6 Diesel	w/Intercooler	6980081

SENSORS

Air Charge/Temperature Sensors

1999	5.9L, I6 Diesel	VIN code D	TS10197-11B1
1998-1994	5.9L, I6 Diesel	VIN code C & D	TS10133-11B1
1998-1994	5.9L, I6 Diesel	VIN code C & D	TS10197-11B1

Coolant Temperature Sensors

2002-1999	5.9L, I6 Diesel	VIN code 6	TS10135-11B1
1999-1998	5.9L, I6 Diesel	VIN code D	TS10135-11B1
1997	5.9L, I6 Diesel	VIN code D	TS10131-11B1
1995-1994	5.9L, I6 Diesel	VIN code C	TS10019-11B1
1991	5.9L, I6 Diesel	VIN code C	TS10019-11B1
1991-1989	5.9L, I6 Diesel	VIN code 8	TS10019-11B1

Crankshaft Position Sensors

2000	5.9L, I6 Diesel	VIN code 6	SS10128-11B1
1996-1994	5.9L, I6 Diesel	VIN code C w/Auto Transmission	SS10177-11B1
1996-1994	5.9L, I6 Diesel	VIN code C w/Manual Transmission	SS10178-11B1
1993-1991	5.9L, I6 Diesel	VIN code C	SS10178-11B1
1991-1990	5.9L, I6 Diesel	VIN code 8	SS10178-11B1

Throttle Position Sensor

1991	5.9L, I6 Diesel	VIN code 2, 8, C	SS10441-11B1
------	-----------------	------------------	--------------

VACUUM PUMP & PODS

2005-2003	5.9L, I6 Diesel	POD only	POD4342
2002-1990	5.9L, I6 Diesel	w/Intercooler	EXLVP2756*
1993-1988	5.9L, I6 Diesel	w/o Intercooler	NLVP4013

WATER PUMP

2002-1989	5.9L, I6 Diesel		WP7123
-----------	-----------------	--	--------

ALTERNATORS.....	20
STARTERS	20
EGR VALVES.....	20
ELECTRONIC CONTROL UNITS.....	20
FEED PUMPS	21
INJECTOR INSTALLATION KITS	21
INJECTOR SEALS.....	21
PUMP MOUNTING KIT	21
VALVE COVER GASKETS & SEAL KITS.....	22
INJECTORS	22
NOZZLES.....	22
GLOW PLUGS.....	22
GLOW PLUG CONTROLLERS.....	22
HIGH PRESSURE OIL PUMPS & COMPONENTS.....	22
AIR CHARGE/TEMPERATURE SENSORS	23
CAM POSITION SENSORS	23
CRANKSHAFT POSITION SENSOR	23
ENGINE COOLANT SENSORS	23
ENGINE OIL SENSOR	24
EXHAUST BACK PRESSURE SENSORS	24

EXHAUST BACK PRESSURE REGULATOR	24
INTAKE AIR TEMPERATURE SENSOR	24
MANIFOLD AIR TEMPERATURE SENSOR.....	24
MAP SENSOR.....	24
INJECTION CONTROL PRESSURE SENSORS	24
OIL PRESSURE SWITCHES.....	24
THROTTLE POSITION SENSORS	25
VACUUM PUMPS.....	25
WATER PUMPS.....	25



EGR Valve

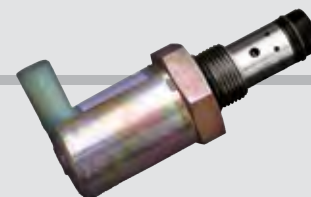
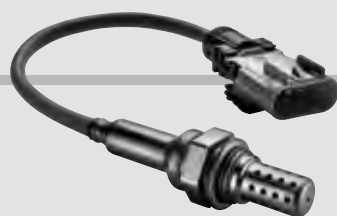

Year Model/Engine Description Part Number

ALTERNATORS †

1999	7.3L Diesel	105 amp (ambulance Pkg).....	RM1563*
1997-1995	7.3L Diesel	130 amp.....	RM1535*
1999	7.3L Diesel	105 amp (ambulance Pkg).....	RM1564*
1998-1995	7.3L Diesel	215 amp (ambulance Pkg).....	RM3749*
1994-1992	7.3L Diesel	130 amp internal regulator, all F Series & 2nd Design E Series....	RM1535*
1992	7.3L Diesel	130 amp internal regulator, 1st Design E Series only.....	RM1550*
1992-1983	7.3L Diesel	100 amp external regulator w/3:00 Plug.....	RM1596*
1992-1983	7.3L Diesel	100 amp external regulator w/9:00 Plug.....	RM1508*
1992-1983	7.3L Diesel	100 amp external regulator w/12:00 Plug.....	RM1509*
1992-1983	6.9L/7.3L Diesel	70 amp external regulator w/12:00 Plug.....	RM1595*
1992-1983	6.9L/7.3L Diesel	70 amp external regulator w/3:00 Plug.....	RM1507*
1992-1983	6.9L/7.3L Diesel	65 amp external regulator.....	RM1505*
1989-1986	6.9L/7.3L Diesel	65 amp internal regulator.....	RM1520*
1989-1986	6.9L/7.3L Diesel	75 amp internal regulator.....	RM1588*

STARTERS

2000-1994	7.3L Diesel	SX3461*
2002-2001	7.3L Diesel	SX3467*
2002-2001	7.3L Diesel	SX3468*
1994	7.3L Diesel	w/oTurbo 2nd production.....	SX3496*
1994-1983	6.9L/7.3L Diesel	SX3456*
1983	6.9L Diesel	Delco model.....	SX1103*

EGR VALVES

2006 07/04	6.0L Diesel	w/valve number 4043H.....	HTV104
07/04 2003	6.0L Diesel	w/valve number 4279L.....	HTV105

ELECTRONIC CONTROL UNITS

E Series

2003-2001	V8, 7.3L, 445, F	EC10627-11B1*
1999-1998	V8, 7.3L, 445, F	EC10617-11B1*
1999-1998	V8, 7.3L, 445, F	EC10619-11B1*
1996-1992	V8, 7.3L, 445, F & M	EC10358-11B1*
2002	V8, 7.3L, 445, F	EC10621-11B1*
2000	V8, 7.3L, 445, F	EC10624-11B1*
1997	V8, 7.3L, 445, F	EC10614-11B1*
1996	V8, 7.3L, 445, F	EC10276-11B1*

F Series

2003-2002	V8, 7.3L, 445, F	EC10628-11B1*
2003-2002	V8, 7.3L, 445, F	EC10310-11B1*

Year Model/Engine Description Part Number

ELECTRONIC CONTROL UNITS (cont.)

F Series (cont.)

2003-2002	V8, 7.3L, 445, F	EC10630-11B1*
2001-2000	V8, 7.3L, 445, F	EC10620-11B1*
2001-2000	V8, 7.3L, 445, F	EC10626-11B1*
2000-1999	V8, 7.3L, 445, F	EC10622-11B1*
1996-1994	V8, 7.3L, 445, F & K	EC10289-11B1*
1996-1992	V8, 7.3L, 445, C, F, K, M	EC10358-11B1*
2002	V8, 7.3L, 445, F	EC10631-11B1*
2001	V8, 7.3L, 445, F	EC10625-11B1*
2001	V8, 7.3L, 445, F	EC10319-11B1*
2001	V8, 7.3L, 445, F	EC10804-11B1*
2000	V8, 7.3L, 445, F	EC10334-11B1*
2000	V8, 7.3L, 445, F	EC10623-11B1*
1999	V8, 7.3L, 445, F	EC10615-11B1*
1999	V8, 7.3L, 445, F	EC10616-11B1*
1999	V8, 7.3L, 445, F	EC10618-11B1*
1997	V8, 7.3L, 445, F	EC10276-11B1*

FEED PUMPS

2002-1998	7.3L Diesel	Electric.....	HFP920
1997-1994	7.3L Diesel	HFP917
1994-1988	7.3L Diesel	HFP907
1987-1982	6.9L Diesel	HFP907
1993-1986	7.8L/6.6L Diesel	Fitted w/Bosch 'P' pump.....	HFP948
N/A	6B 5.9L	Cummins.....	HFP700
N/A	6CT, 6CTA 8.3L	Cummins.....	HFP700
N/A	6CT, 6CTA 8.3L	Cummins.....	HFP916
N/A	6CT, 6CTA 8.3L	Cummins (Electric).....	HFP923

INJECTOR INSTALLATION KITS

1994-3/1992	7.3L Diesel	7135-276
2/1992-1985	6.9L/7.3L Diesel	7135-264

INJECTOR SEALS

1988-1983	6.9L/7.3L Diesel	Copper Washer.....	7169-541
-----------	------------------	--------------------	----------

PUMP MOUNTING KIT

1994-1983	6.9L/7.3L Diesel	7135-275
-----------	------------------	-------	----------

† Supplied with 8-groove pulley. May need to change pulley for some applications.

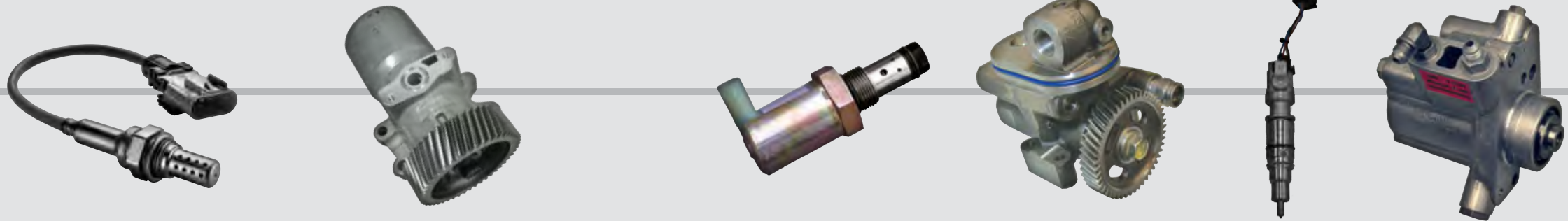

Year	Model/Engine	Description	Part Number
------	--------------	-------------	-------------

VALVE COVER GASKETS & SEAL KITS

2002-1997	7.3L Diesel	Valve Cover Gasket Engine s/n 661895 and up.....	7135-285
1997-1994	7.3L Diesel	Valve Cover Gasket Engine s/n 0 - 661894.....	7135-284
2002-1997	7.3L Diesel	Valve Cover Harness Kit-Engine s/n 661895 and up.....	HTP119
1997-1994	7.3L Diesel	Valve Cover Harness Kit-Engine s/n 0 - 661894.....	HTP110
2002-1994	7.3L Diesel	Injector O-ring Kit (one per injector)	HTP109

INJECTORS

2006-2004	6.0L, 4.5L	Engines built 9/22/03 and up.....	EX636692*
2004-2003	6.0L	Engines built before 9/21/03.....	EX633089*
1997-1991	7.5L Gas	F-53.....	FJ10109-11B1
1991-1989	7.5L Gas	F-53.....	FJ10202-11B1
1994-1992	7.3L Diesel	Turbo	LJCK01102
1994-1992	7.3L Diesel	LJCK01101
1992-1984	6.9L/7.3L Diesel	6760301
1991	7.0L Gas	B Series.....	621015

NOZZLES

1994-3/1992	7.3L Turbo Diesel	w/Stanadyne-Ambac Type Injectors	6801169
1994-3/1992	7.3L Diesel	w/Stanadyne-Ambac Type Injectors	6801168
2/1992-1984	6.9L/7.3L Diesel	w/Delphi Type Injectors.....	6801036
		w/Stanadyne-Ambac Type Injectors	6801069
1983	6.9L Diesel	w/Delphi Type Injectors.....	6801028
		w/Stanadyne-Ambac Type Injectors	6801068

GLOW PLUGS

2007-2004	6.0L Diesel	Engine s/n 6155636 and up	HDS806
2002-1995	7.3L Diesel	HDS310
1994-1988	7.3L Diesel	HDS307
1987	6.9L Diesel	HDS307
1986-1983	6.9L Diesel	HDS305

GLOW PLUG CONTROLLERS

2005-2002	6.0L Diesel	Relay	HDC912
2002-1994	7.3L Diesel	Relay	HDC908
1994-1988	7.3L Diesel	HDC906
1987-1983	6.9L Diesel	HDC905

HIGH PRESSURE OIL PUMPS & COMPONENTS

2007-2005	6.0L Diesel	Engine s/n 6,344,943 and up	HTP122
-----------	-------------	-----------------------------------	--------

Year	Model/Engine	Description	Part Number
------	--------------	-------------	-------------

HIGH PRESSURE OIL PUMPS & COMPONENTS (cont.)

2004-2003	6.0L Diesel	Engine s/n 0 - 6,344,942	HTP123*
2002-2000	7.3L Diesel	Engine s/n 843990 and up	HTP108*
1999-1998	7.3L Diesel	Engine s/n 661895 - 843989	HTP107*
1997-1996	7.3L Diesel	Engine s/n 216544 - 661894	HTP105*
1995-1994	7.3L Diesel	Engine s/n 00500 - 216543	HTP104*
2007-2005	6.0L Diesel	IPR Valve-engine s/n 6,344,943 and up.....	HTV102
2004-2003	6.0L Diesel	IPR Valve-engine s/n 0 - 6,344,942.....	HTV110
2002-1995.5	7.3L Diesel	IPR Valve w/o edge filter, engine s/n 216544 and up.....	HTF101
1995.5-1994	7.3L Diesel	IPR Valve w/edge filter, engine s/n 0 - 216543	HTF100
2002-1994	7.3L Diesel	IPR Valve O-ring kit	HTK100

AIR CHARGE/TEMPERATURE SENSORS

2002-1999	7.3L Diesel	from 1/12/1998, mounted on air cleaner	TS10023-11B1
2002-1999	7.3L Diesel	from 1/12/1998, mounted on air cooler manifold.....	TS10098-11B1
1998	7.3L Diesel	Plastic Sensor.....	TS10023-11B1
1998	7.3L Diesel	Metal Sensor	TS10098-11B1
1997	7.3L Diesel	TS10023-11B1
1997-1995	7.3L Diesel	Metal Sensor	TS10201-11B1

CAM POSITION SENSORS

2007-2003	6.0L Diesel	HTS126
2002-1996.5	7.3L Diesel	Engine s/n 375549 and up	HTS101
2002-1996.5	7.3L Diesel	HTS101 Alternative.....	HTS101G
1996.5-1994	7.3L Diesel	Engine s/n 0 - 3755480	HTS100

CRANKSHAFT POSITION SENSOR

2007-2003	6.0L Diesel	HTS132
-----------	-------------	-------	--------

ENGINE COOLANT SENSORS

2007-2003	6.0L Diesel	HTS125
1996	7.5L, 460,G	E-Super Duty (V8)	TS10001-11B1
1996, 1994	7.5L, 460,G	E-250 Econoline.....	TS10001-11B1
1991-1988	7.5L, 460,G	E-250 Econoline Club Wagon	TS10001-11B1
1998-1997	6.8L, 415,S	E-350 Econoline Super (V10).....	TS10001-11B1
1998-1997	6.8L, 415,S	E-350 Econoline Super Wagon (V10)	TS10001-11B1
1996-1988	7.5L, 460,G	E-350 Econoline.....	TS10001-11B1
1996-1992	7.5L, 460,G	E-350 Econoline HD Club Wagon	TS10001-11B1
1996-1988	7.5L, 460,G	E-350 Econoline Super	TS10001-11B1
1996-1995	7.5L, 460,G	E-250 Econoline Super	TS10001-11B1
1996-1988	7.5L, 460,G	E-350 Econoline Super Wagon.....	TS10001-11B1
1997-1988	7.5L, 460,G	F-350 Pickup Super Cab	TS10001-11B1

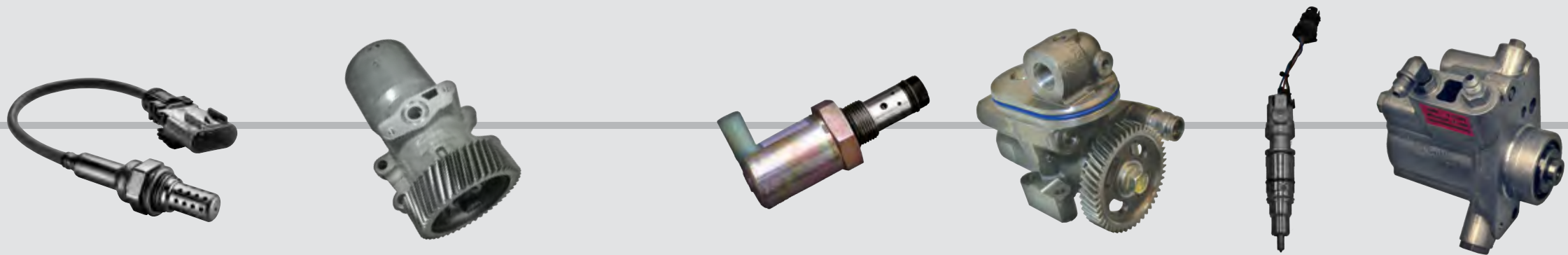

Year Model/Engine Description Part Number

ENGINE COOLANT SENSORS (cont.)

1997-1988	7.5L, 460, G	F-450 Super Duty Pickup Truck	TS10001-11B1
1997-1989	7.5L, 460, G	F-53 stripped chassis	TS10001-11B1

ENGINE OIL SENSOR

2005-2003	6.0L Diesel	HTS125
-----------	-------------	-------	--------

EXHAUST BACK PRESSURE SENSORS

2002-1996.5	7.3L Diesel	Engine s/n 375549 and up	HTS105
1996.5-1994	7.3L Diesel	Engine s/n 0 - 375548	HTS104

EXHAUST BACK PRESSURE REGULATOR

2002-1994	7.3L Diesel	HTS106
-----------	-------------	-------	--------

INTAKE AIR TEMPERATURE SENSOR

2005-2003	6.0L Diesel	HTS131
-----------	-------------	-------	--------

MANIFOLD AIR TEMPERATURE SENSOR

2007-2003	6.0L Diesel	HTS128
-----------	-------------	-------	--------

MAP SENSOR

1991	7.0L Gas	B Series	PS10062-11B1
------	----------	----------------	--------------

INJECTION CONTROL PRESSURE SENSORS

2007-2003	6.0L Diesel	HTS127
2002-1996	7.3L Diesel	Engine s/n 375549 and up	HTS102
1996-1994	7.3L Diesel	Engine s/n 0 - 375548	HTS103

OIL PRESSURE SWITCHES

2007-2003	6.0L Diesel	Sensor	HTS129
1999-1990	10.5L	B700 w/gauge	SS10459-11B1
1999-1990	7.0L Gas	B700 w/gauge w/o direct read	SS10459-11B1
1999-1990	6.0L Gas	B700 w/gauge	SS10333-11B1

Year Model/Engine Description Part Number

THROTTLE POSITION SENSORS

1997	7.5L Gas	F53	SS10387-11B1
1996	7.5L Gas	F53 Gas	SS10387-11B1
1996	7.5L Gas	F53 Gas	SS10449-11B1
1995-1994	7.5L Gas	F53 Gas	SS10449-11B1
1993	7.5L Gas	F53	SS10428-11B1
1993	7.5L Gas	F53	SS10450-11B1
1992-1989	7.5L Gas	F53	SS10428-11B1
1995-1988	6.9L/7.3L Diesel	SS10423-11B1
1991	7.0L Gas	B Series D	SS10428-11B1

VACUUM PUMPS

E Series

2002-1997	7.3L Diesel	Powerstroke	NLVP4342/POD4342
1996-1995	7.3L Diesel	Powerstroke	NLVP5041/POD5041
1994-3/1992	7.3L Diesel	NLVP9897/POD9897
2/1992-1988	7.3L Diesel	NLVP4092/POD4092
1987-1983	6.9L Diesel	NLVP4092/POD4092

F Series

2002-1996	7.3L Diesel	Powerstroke	NLVP4342/POD4342
1996-1994	7.3L Diesel	Powerstroke	NLVP5041/POD5041
1993-3/92	7.3L Diesel	NLVP9897/POD9897
2/92-1988	7.3L Diesel	NLVP4092/POD4092
1987-1983	6.9L Diesel	NLVP4092/POD4092

WATER PUMPS

2002-1996	7.3L Diesel	WP5885
1996-1994	7.3L Diesel	WP5903
1994-1988	7.3L Diesel	WP8585
1987-1983	6.9L Diesel	WP8585

* For core criteria information, please see page 84.

* For core criteria information, please see page 84.

EGR VALVE	28
ELECTRONIC CONTROL UNITS.....	28
ALTERNATORS.....	29
STARTERS	29
FEED PUMPS	29
INJECTOR INSTALLATION KITS	30
INJECTORS	30
NOZZLES.....	31
GLOW PLUGS, CONTROLLERS, INTAKE HEATER RELAYS	31
AIR CHANGE/TEMP SENSORS.....	31
BOOST SENSOR.....	31
CAMSHAFT POSITION SENSORS.....	32
CRANK POSITION SENSORS.....	32
ENGINE COOLANT SENSORS.....	32
FUEL FILTER SENSOR.....	32
FUEL TEMP SENSOR	32
INTAKE AIR TEMP SENSORS.....	32
KNOCK SENSORS	32
MAP SENSORS	33
OXYGEN SENSORS.....	33

OIL PRESSURE SENSOR	33
TPS SENSORS	33
VACUUM REGULATING VALVE	33
VACUUM SENSOR	33
VACUUM PUMPS.....	33
WATER PUMPS	35
FUEL FILTER.....	35



Vacuum Pump

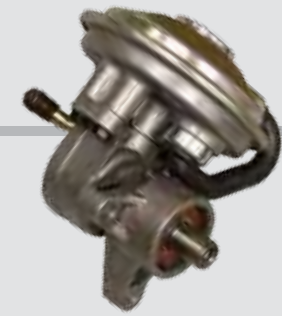

Year	Model/Engine	Description	Part Number
EGR VALVE			
2003-2000	6.6L Diesel	No gasket required	HTV109

ELECTRONIC CONTROL UNITS

C/K Series Trucks

2006-2005	V8, 6.0L, 364, U	EC10038-11B1*
2006	V8, 6.0L, 364, U	EC10037-11B1*
2006-2005	V8, 8.1L, 496, G	EC10037-11B1*
2004	V8, 6.0L, 364, U	EC10036-11B1*
2004	V8, 6.0L, 364, U	EC10035-11B1*
2003	V8, 6.0L, 364, N	EC10031-11B1*
2003	V8, 6.0L, 364, U	EC10031-11B1*
2003	V8, 8.1L, 496, G	EC10030-11B1*
2002-2001	V8, 6.0L, 364, U	EC10010-11B1*
2002-2001	V8, 6.5L, 395, F	Turbo Diesel	EC10016-11B1*
2002-2001	V8, 8.1L, 496, G	EC10010-11B1*
2000-1999	V8, 7.4L, 454, J	EC10027-11B1*
2000-1996	V8, 6.5L, 395, F or S	Turbo Diesel	EC10016-11B1*
1997	V8, 7.4L, 454, J	EC10020-11B1*
1996	V8, 7.4L, 454, J	EC10025-11B1*
1995-1994	V8, 7.4L, 454, N	EC10014-11B1*
1995	V8, 6.5L, 395, P	Diesel	EC10072-11B1*
1995	V8, 6.5L, 395, F or S	Turbo Diesel	EC10072-11B1*
1994	V8, 6.5L, 395, P	Diesel	EC10055-11B1*
1994	V8, 6.5L, 395, F or S	Turbo Diesel	EC10055-11B1*
1993	V8, 6.2L, 379, C	EC10089-11B1*

G Series Vans

2006-2005	V8, 6.0L, 364, U	EC10037-11B1*
2004	V8, 6.0L, 364, U	EC10036-11B1*
2003	V8, 6.0L, 364, U	EC10030-11B1*
2002-2001	V8, 8.1L, 496, G	EC10010-11B1*
2002-1999	V8, 6.5L, 395, F	Turbo Diesel.....	EC10016-11B1*
2000-1999	V8, 7.4L, 454, J	EC10027-11B1*
1998	V8, 6.5L, 395, F	EC10016-11B1*
1997	V8, 7.4L, 454, J	EC10020-11B1*
1997-1996	V8, 6.5L, 395, F	Turbo Diesel.....	EC10016-11B1*
1996	V8, 6.5L, 395, F	EC10025-11B1*
1995	V8, 6.5L, 395, P	EC10072-11B1*
1993	V8, 6.2L, 379, C	EC10089-11B1*
1996	V8, 7.4L, 454, J	EC10025-11B1*
1996-1994	V8, 7.4L, 454, N	EC10014-11B1*
1994	V8, 6.5L, 395, P	EC10055-11B1*

Year	Model/Engine	Description	Part Number
ELECTRONIC CONTROL UNITS (cont.)			

P Series Vans

1999	V8, 7.4L, 454, J	EC10027-11B1*
1999-1996	V8, 6.5L, 395, Y	Diesel	EC10016-11B1*
1999-1996	V8, 6.5L, 395, F	Turbo Diesel.....	EC10016-11B1*
1997	V8, 7.4L, 454, J	Turbo Diesel.....	EC10020-11B1*
1996	V8, 7.4L, 454, J	EC10025-11B1*
1997-1994	V8, 7.4L, 454, N	EC10014-11B1*
1996-1995	V8, 6.5L, 395, F	Turbo Diesel.....	EC10072-11B1*
1994	V8, 6.5L, 395, F	Turbo Diesel.....	EC10055-11B1*

ALTERNATORS

2003-2000	6.6L Diesel	w/105 amp	RM1385*
2003-2000	6.6L Diesel	w/130 amp	RM1386*
1998	6.5L Diesel	w/100 amp internal fan units	RM1024*
1998	6.5L Diesel	w/140 amp external fan, option	RM1360*
1998-1996	6.5L Diesel	w/105 amp internal fan unit, std.	RM1039*
1998-1996	6.5L Diesel	w/124 amp external fan, option	RM1036*
1996-1994	6.5L Diesel	w/100 amp w/Turbo, std, 2nd production	RM1004*
1995-1993	6.2/6.5L Diesel	w/100 amp w/Turbo, std, 1st production.	RM1009*
1995-1993	6.2/6.5L Diesel	w/105 amp w/Turbo, option.....	RM1055*
1992-1988	6.2/6.5L Diesel	w/105 amp w/A.C	RM1612*
1992-1987	6.2/6.5L Diesel	w/100 amp w/o A.C.	RM1013*

STARTERS

2003-2000	6.6L Diesel	SX3469*
1998-1989	6.2/6.5L Diesel	All models except below.	SX1104*
1994-1989	6.2/6.5L Diesel	4WD models w/Manual Transmission.	SX1124*

FEED PUMPS

C/K Series Trucks

2007-2001	6.6L Diesel	HFP955
2002-1999	6.5L TurboDiesel	HFP922
1998-1994	6.5L TurboDiesel	HFP921
1995-1994	7.4L, N Gas	FE0112-11B1
1995-1994	6.5L Diesel	HFP921
1993-1992	6.5L Diesel	HFP905
1998-1990	7.0L Gas	FE0112-11B1
1998-1990	6.0L Gas	FE0112-11B1
1993-1988	6.2L Diesel	HFP905
1986-1982	6.2L Diesel	HFP906

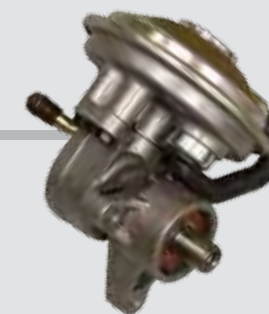

Year	Model/Engine	Description	Part Number
------	--------------	-------------	-------------

FEED PUMPS (cont.)

R/V Series Trucks

1991-1990	6.2L Diesel	HFP909
1989-1987	6.2L Diesel	HFP906
1989-1988	6.2L Diesel	Frame Mounted.....	HFP905

G Series Vans

2007-2001	6.6L Diesel	HFP955
2002-1999	6.5L Turbo Diesel	HFP922
1998-1996	6.5L Turbo Diesel	HFP921
1996-1994	7.4L, N Gas	FE0112-11B1
1996-1994	6.5L Diesel	HFP909
1993-1990	6.2L Diesel	HFP909
1993-1982	6.2L Diesel	HFP906
1988	6.2L Diesel	Frame Mounted.....	HFP905

P Series Vans

1999	6.5L Turbo Diesel	HFP922
1999	6.5L Diesel	HFP922
1998	6.5L Diesel	HFP921
1998-1994	6.5L Turbo Diesel	HFP921
1997-1994	6.5L Diesel	HFP909
1997	7.4L, N Gas	Exc 80 Gallon Gas Tank.....	FE0112-11B1
1995-1994	7.4L, N Gas	FE0112-11B1
1998-1990	7.0L Gas	FE0112-11B2
1998-1990	6.0L Gas	FE0112-11B3
1993-1990	6.2L Diesel	HFP909

INJECTOR INSTALLATION KITS

2000-1982	6.2L/6.5L Diesel	7135-274
1995-1982	6.2L/6.5L	w/Stanadyne pump.....	7135-263

INJECTORS

2002-1999	7.4L Gas	FJ10058-11B1
1998-1990	7.0L Gas	FJ10060-11B1
2002-1990	6.0L Gas	FJ10060-11B1
1999-1992	6.5L Diesel	C, K, G Series Turbocharged.....	6703803
1994-1992	6.5L Diesel	C, K, G, P Series Natural Aspirated.....	6703802
1994-1991	6.2L Diesel	All Model Series.....	6703802
1990-1988	6.2L Diesel	C, K Series	6703801
1986-1983	6.2L Diesel	C, K, Series	6704001
1991-1987	6.2L Diesel	R, V Series.....	6703801
1993-1991	6.2L Diesel	G Series	6703802
1990-1983	6.2L Diesel	G Series	6703801

Year	Model/Engine	Description	Part Number
------	--------------	-------------	-------------

INJECTORS (cont.)

1990-1989	6.2L Diesel	P Series	6703801
1988-1983	6.2L Diesel	P Series	6704001

NOZZLES

1999-1992	6.5L Diesel	C, K, G Series Turbocharged.....	5643862
1994-1991	6.2L/6.5L Diesel	C, K, G, P Series	5643862
1990-1988	6.2L Diesel	C, K, R, V, P Series	5643810
1987-1982	6.2L Diesel	C, K, R, V, P Series	5643808
1990-1983	6.2L Diesel	G Series	5643810

GLOW PLUGS, CONTROLLERS, INTAKE HEATER RELAYS

2003-2000	6.6L Diesel	HDS802
2002-1992	6.5L Diesel	HDS309
1993-1982	6.2L Diesel	HDS306
2002-1992	6.5L Diesel	Military (24v version bullet connector)	HDS801
1991-1984	6.2L/6.5L Diesel	Military (12v version spade connector).....	HDS800
2003-2000	6.6L Diesel	Glow Plug connector	HTP120
2003-2000	6.6L Diesel	Intake Heater w/o gasket (use 7135-286).....	HDS803
2003-2000	6.6L Diesel	Intake Heater Gasket.....	7135-294
2003-2000	6.6L Diesel	Controller.....	HDC911
2003-2000	6.6L Diesel	Controller w/California Diagnostics.....	HDC910
2002-1994	6.5L Diesel	Controller.....	HDC907
1993-1992	6.5L Diesel	Controller.....	HDC904
1993-1985	6.2L Diesel	Controller.....	HDC904
1984-1982	6.2L Diesel	Controller.....	HDC903
2003-2000	6.6L Diesel	Intake Heater relay	HTS107
1979-1978	5.7L, 350, N	Glow Plug	HDS308
1979-1978	5.7L, 350, N	Controller.....	HDC900

AIR CHANGE/TEMP SENSORS

2002-1994	6.5L, F Diesel	TS10080-11B1
1997-1994	6.5L, P Diesel	TS10072-11B1
1998-1994	6.5L, S Diesel	TS10080-11B1

BOOST SENSOR

2003-2000	6.6L Diesel	HTS115
-----------	-------------	-------	--------

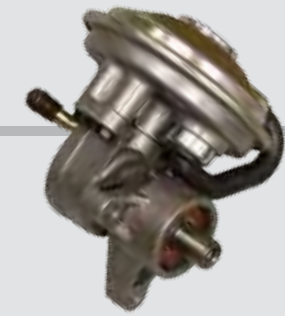

Year Model/Engine Description Part Number

CAMSHAFT POSITION SENSORS

2003-2000 6.6L Diesel HTS109

CRANK POSITION SENSORS

2003-2000 6.6L Diesel HTS114
2000-1994 6.5L Diesel SS10126-11B1

ENGINE COOLANT SENSORS

2003-2000 6.6L Diesel TS10075-11B1
2002-1991 7.0L Gas TS10032-11B1
1998-1997 6.5L Diesel TS10078-11B1
2002-1992 6.5L, F Diesel TS10075-11B1
1998-1994 6.5L, S Diesel TS10075-11B1
1996-1994 6.5L, P Diesel TS10075-11B1
1996-1994 6.5L, Y Diesel TS10075-11B1
1995-1994 6.5L, P, Y Diesel TS10078-11B1
1993-1992 6.2L, C, J Diesel TS10078-11B1
1993-1992 6.2L, C, J Diesel TS10075-11B1
2002-1991 6.0L Gas TS10032-11B1
1991-1985 6.2L, J Diesel TS10075-11B1
1991-1985 6.2L, J Diesel TS10138-11B1

FUEL FILTER SENSOR

2003-2000 6.6L Diesel HTS110

FUEL TEMP SENSOR

2003-2000 6.6L Diesel HTS108

INTAKE AIR TEMP SENSORS

2000 7.4L Gas TS10072-11B1
1998 6.5L, F Diesel TS10090-11B1

KNOCK SENSORS

1996-1993 7.0L Gas AS10015-11B1
1996-1993 6.0L, Gas AS10015-11B1

Year Model/Engine Description Part Number

MAP SENSORS

2003-2000 6.6L Diesel HTS113
1998-1990 7.4L Gas PS10075-11B1
1998-1990 7.0L Gas PS10075-11B1
1993-1992 6.5L Diesel PS10000-11B1
1991 6.5L Diesel PS10074-11B1
1999-1998 6.5L Diesel Standard PS10000-11B1
1999-1998 6.5L Diesel Optional D PS10074-11B1
1991 6.2L Diesel w/Automatic Transmission D PS10074-11B1
1998-1990 6.0L Gas PS10075-11B1

OXYGEN SENSORS

1999 7.4L Gas ES10008-11B1
1998-1990 7.0L Gas ES10039-11B1
1998-1990 6.0L Gas ES10039-11B1

OIL PRESSURE SENSOR

2003-2000 6.6L Diesel w/gauge HTS111

TPS SENSORS

2002-1990 7.0L Gas SS10425-11B1
2002-1990 6.0L Gas SS10425-11B1
2000-1996 6.5L, F Diesel SS10382-11B1
1999-1996 6.5L, S Diesel SS10382-11B1

VACUUM REGULATING VALVE

2003-2000 6.6L Diesel HTS119

VACUUM SENSOR

2003-2000 6.6L Diesel HTS112

VACUUM PUMPS

C/K Series Trucks

2003-2000 6.6L Diesel NLVP3450/POD3450
2000-1996 6.5L Diesel NLVP3450/POD3450
1995 6.5L Diesel w/A.C. NLVP1790/POD1790
1995 6.5L Diesel w/o A.C. NLVP3357/POD3357
1994-1992 6.5L Diesel w/o A.C. NLVP2968/POD2968

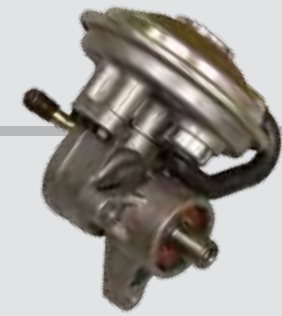

Year	Model/Engine	Description	Part Number
------	--------------	-------------	-------------

VACUUM PUMPS (cont.)

C/K Series Trucks (cont.)

1994-1992	6.5L Diesel	w/A.C.....	NLVP1790/POD1790
1993-1988	6.2L Diesel	NLVP2968/POD2968
1993-1988	6.2L Diesel	w/A.C.....	NLVP1790/POD1790
1986-1982	6.2L Diesel	NLVP1697/POD1697
1985-1984	6.2L Diesel	w/speed sensor (cal)	NLVP1696/POD1696

R/V Series Trucks

1991-1987	6.2L Diesel	NLVP1697/POD1697
1991-1987	6.2L Diesel	w/speed sensor	NLVP1696/POD1696

Blazer, Suburban, Tahoe

2000-1996	6.5L Diesel	NLVP3450/POD3450
1995	6.5L Diesel	w/A.C.....	NLVP1790/POD1790
1995	6.5L Diesel	w/o A.C.....	NLVP3357/POD3357
1994-1992	6.5L Diesel	w/A.C.....	NLVP1790/POD1790
1994-1992	6.5L Diesel	w/o A.C.....	NLVP2968/POD2968
1991-1987	6.2L Diesel	w/speed sensor	NLVP1696/POD1696
1986-1982	6.2L Diesel	NLVP1697/POD1697
1985-1984	6.2L Diesel	w/speed sensor (cal)	NLVP1696/POD1696

G Series Vans

2000-1996	6.5L Diesel	NLVP3450/POD3450
1996	6.5L Diesel	w/A.C.....	NLVP3357/POD3357
1995-1994	6.5L Diesel	NLVP3357/POD3357
1993-1984	6.2L Diesel	Belt Driven	NLVP8253/POD8253
1989-1982	6.2L Diesel	Gear Driven	NLVP1697/POD1697

P Series

2000-1996	6.5L Diesel	NLVP3450/POD3450
1995-1994	6.5L Diesel	NLVP3357/POD3357
1990-1984	6.2L Diesel	Belt Driven	NLVP8253/POD8253
1989-1982	6.2L Diesel	Gear Driven	NLVP1697/POD1697

Year	Model/Engine	Description	Part Number
------	--------------	-------------	-------------

WATER PUMPS

C/K Series Pickups

2003-2000	6.6L Diesel	w/o gasket (use 7135-295)	WP8721
2003-2000	6.6L Diesel	Water Pump Gasket	7135-295
2000-1999	6.5L, F Diesel	(pressed on pulley for fan)	WP4913
1999-1996	6.5L, F, S Diesel	(threaded on pulley for fan & 2 thermostats)	WP4925
1996-1992	6.5L, F, P, S, Diesel	(1 thermostat)	WP4937
1993-1988	6.2L, C, J Diesel	WP4937
1986-1982	6.2L, C, J Diesel	WP8550

R/V Series Pickups

1987-1986	6.2L, C, J Diesel	WP8550
-----------	-------------------	-------	--------

G & P Series Vans

2000-1999	6.5L, F,Y Diesel	(pressed on pulley for fan)	WP4913
1999-1996	6.5L, F,Y Diesel	(threaded on pulley for fan & 2 thermostats)	WP4925
1996-1992	6.5L, P,Y Diesel	(1 thermostat)	WP4937
1993-1988	6.2L Diesel	WP4937
1986-1982	6.2L Diesel	WP8550

FUEL FILTER

2003-2000	6.6L Diesel	O-rings Included	HTF102
-----------	-------------	------------------------	--------

ALTERNATORS.....	38	CONDENSER.....	48
STARTERS	39	EVAPORATOR	49
EGR VACUUM REGULATOR & EPR SOLENOID VALVES	40	RADIATORS.....	49
EGR VALVES.....	40	CRANKSHAFT POSITION SENSOR	51
ELECTRONIC CONTROL UNITS.....	40	ENGINE COOLANT SENSOR	51
EVAPORATIVE CANISTER PURGE SOLENOID VALVES	41	ENGINE COOLANT TEMPERATURE SENSORS	51
FILTER, EGR VACUUM REGULATOR SOLENOID VALVE.....	41	FUEL SENDER SENSORS	52
IDLE AIR CONTROL VALVES.....	41	KNOCK SENSORS.....	54
FEED PUMPS	42	MAP SENSOR.....	54
FUEL STRAINERS	42	THROTTLE POSITION SENSORS	55
FUEL PRESSURE REGULATOR KITS	43	VEHICLE SPEED SENSORS.....	55
TBI BASKET KITS.....	43	WATER PUMPS	56
TBI SEAL KIT.....	44		
FUEL PRESSURE SERVICE VALVE KITS.....	44		
CRANKSHAFT POSITION SENSOR SEALS - (O-RINGS).....	44		
EGR VALVE GASKETS.....	44		
FUEL SENDER PADS	45		
FUEL FEED PIPE SEALS - (O-RINGS)	45		
FUEL SENDER - (O-RINGS).....	45		
INJECTORS- MULTIPORT	47		
INJECTORS	47		
COMPRESSOR.....	48		



Temperature Sensor



ALTERNATORS

Chevrolet

Year	Model/Engine	Description	Part Number
2002-1999	L6, 7.2L, L,	Turbo	RM20000*
2002-1998	I6, 7.2L, I	Turbo	RM20000*
2000-1999	V8, 7.4L, 454, D	RM20006*
2000-1999	V8, 7.4L, 454, D	RM20007*
1998-1997	V8, 6.0L, 366, P	RM20005*
1998-1997	V8, 6.0L, 366, P	RM20007*
1998-1991	V8, 7.0L, 427, M	RM20005*
1998-1991	V8, 7.0L, 427, M	RM20006*
1998-1990	V8, 7.0L, 427, M	RM20007*
1998-1990	I6, 6.6L, J	Turbo CAT 3116.....	RM20000*
1997	I6, 6.6L, J	Turbo CAT 3116.....	RM20000*
1996-1994	I6, 6.6L, J	Turbo CAT 3116.....	RM20000*
1996-1992	Any	RM20006*
1996-1990	I6, 6.6L, J	Turbo CAT 3116.....	RM20002*
1995-1992	V8, 7.0L, 427, M	RM20008*
1995-1990	V8, 7.0L, 427, M	RM20008*
1994-1990	I6, 6.6L, J	Turbo CAT 3116.....	RM20004*
1990	I6, 6.6L, J	Turbo CAT 3116.....	RM20001*
1990-1988	V8, 7.0L, 427, E	RM20008*
1990-1985	V8, 6.0L, 366,	RM20008*
1990-1983	V8, 8.2L, 502,T	RM20003*
1989-1987	V8, 7.0L, 427, M	RM20008*
1986-1985	V8, 6.0L, 366, P	RM20008*

GMC

2002-1999	I6, 7.2L, L	Turbo	RM20000*
2002-1998	I6, 7.2L, L	Turbo	RM20000*
2000-1999	V8, 7.4L, 454, D	RM20006*
2000-1999	V8, 7.4L, 454, D	RM20007*
1998-1997	V8, 6.0L, 366, P	RM20005*
1998-1997	V8, 6.0L, 366, P	RM20007*
1998-1991	V8, 7.0L, 427, M	RM20005*
1998-1991	V8, 7.0L, 427, M	RM20006*
1998-1990	V8, 7.0L, 427, M	RM20007*
1998-1990	I6, 6.6L, J	Turbo CAT 3116.....	RM20000*
1997	I6, 6.6L, J	Turbo CAT 3116.....	RM20000*
1996-1994	I6, 6.6L, J	Turbo CAT 3116.....	RM20000*
1996-1992	Any	RM20006*
1996-1990	I6, 6.6L, J	Turbo CAT 3116.....	RM20002*
1995-1992	V8, 7.0L, 427, M	RM20008*
1995-1990	V8, 7.0L, 427, M	RM20008*
1994-1990	I6, 6.6L, J	Turbo CAT 3116.....	RM20004*
1990	I6, 6.6L, J	Turbo CAT 3116.....	RM20001*
1990-1988	V8, 7.0L, 427, E	RM20008*
1990-1985	V8, 6.0L, 366, B	RM20008*
1990-1983	V8, 8.2L, 502,T	RM20003*
1989-1987	V8, 7.0L, 427, M	RM20008*
1986-1985	V8, 6.0L, 366, P	RM20008*

STARTERS

Chevrolet

Year	Model/Engine	Description	Part Number
2002-1999	L6, 7.2L, L	Turbo	SX20000*
2002-1999	L6, 7.2L, L	Turbo	SX20001*
2001	V8, 8.1L, 496, E	SX20002*
2001	V8, 8.1L, 496, E	SX20006*
2000-1999	V8, 7.4L, 454, D	SX20002*
2000-1999	V8, 7.4L, 454, D	SX20006*
1998-1997	V8, 6.0L, 366, P	SX20002*
1998-1997	V8, 6.0L, 366, P	SX20006*
1998-1996	V8, 7.0L, 427, M	SX20002*
1998-1996	V8, 7.0L, 427, M	SX20006*
1998-1990	I6, 6.6L, J	Turbo CAT 3116.....	SX20000*
1998-1990	I6, 6.6L, J	Turbo CAT 3116.....	SX20001*
1996	V8, 7.0L, 427, M	SX20002*
1995	V8, 7.0L, 427, M	SX20004*
1995	V8, 7.0L, 427, M	SX20004*
1995-1990	V8, 6.0L, 366, P	SX20005*
1995-1990	V8, 7.0L, 427, M	SX20003*
1990-1988	V8, 7.0L, 427, E	SX20004*
1990-1985	V8, 6.0L, 366, B	SX20004*
1990	V8, 6.0L, 366, P	SX20003*
1989-1987	V8, 5.7L, 350, M	SX20004*
1989-1985	Any	SX20003*
1986-1985	V8, 5.7L, 350, P	SX20004*
1986-1985	V8, 6.0L, 366, B	SX20003*

GMC

2002-1999	I6, 7.2L, L	Turbo	SX20000*
2002-1999	I6, 7.2L, L	Turbo	SX20001*
2001	V8, 8.1L, 496, E	SX20002*
2001	V8, 8.1L, 496, E	SX20006*
2000-1999	V8, 7.4L, 454, D	SX20002*
2000-1999	V8, 7.4L, 454, D	SX20006*
1998-1997	V8, 6.0L, 366, P	SX20002*
1998-1997	V8, 6.0L, 366, P	SX20006*
1998-1996	V8, 7.0L, 427, M	SX20002*
1998-1996	V8, 7.0L, 427, M	SX20006*
1998-1990	I6, 6.6L, J	Turbo CAT 3116.....	SX20000*
1998-1990	I6, 6.6L, J	Turbo CAT 3116.....	SX20001*
1996	V8, 7.0L, 427, M	SX20002*
1995-1992	V8, 7.0L, 427, M	SX20004*
1995-1990	V8, 7.0L, 427, M	SX20003*
1995-1990	V8, 7.0L, 427, M	SX20004*
1995-1990	V8, 6.0L, 366, P	SX20005*
1990-1988	V8, 7.0L, 427, E	SX20004*
1990-1985	V8, 6.0L, 366, B	SX20004*
1990	V8, 6.0L, 366, P	SX20003*
1989-1987	V8, 5.7L, 350, M	SX20004*
1989-1985	Any	SX20003*

* For core criteria information, please see page 84.

* For core criteria information, please see page 84.



STARTERS (cont.)

GMC (cont.)

Year	Model/Engine	Description	Part Number
1986-1985	V8, 6.0L, 366, B	SX20003*
1986-1985	V8, 5.7L, 350, P	SX20004*

EGR VACUUM REGULATOR & EPR SOLENOID VALVES

Chevrolet

1998-1997	V8, 6.0L, 366, P	HTV106
1998-1990	V8, 7.0L, 427, M	HTV106
1996-1992	V8, 7.0L, 427, M	HTV106
1997	V8, 6.0L, 366, P	HTV106

GMC

1998-1997	V8, 6.0L, 366, P	HTV106
1998-1990	V8, 7.0L, 427, M	HTV106
1996-1992	V8, 7.0L, 427, M	HTV106
1995-1993	V8, 5.7L, 350, K	HTV106

EGR VALVES

Chevrolet

1997-1995	V8, 5.7L, 350, R	EG10026-11B1
1996-1995	V8, 5.7L, 350, R	EG10026-11B1
1998	V8, 5.7L, 350, R	EG10026-11B1

GMC

1998-1997	V8, 5.7L, 350, R	EG10026-11B1
1994-1993	V8, 5.7L, 350, R	EG10127-11B1

ELECTRONIC CONTROL UNITS

Chevrolet

2006-2005	V8, 8.1L, 496, E	EC10037-11B1*
2004	V8, 8.1L, 496, E	EC10036-11B1*
2003	V8, 8.1L, 496, E	EC10030-11B1*
2002	V8, 8.1L, 496, G	EC10010-11B1*
2005-2001	V8, 8.1L, 496, E	EC10010-11B1*
2001	Any	EC10010-11B1*
1999	Any	EC10025-11B1*
1998-1997	V8, 6.5L, 395, F	EC10016-11B1*

GMC

2006-2005	V8, 8.1L, 496, E	EC10037-11B1*
2004	V8, 8.1L, 496, E	EC10036-11B1*

ELECTRONIC CONTROL UNITS (cont.)

GMC (cont.)

2003	V8, 8.1L, 496, E	EC10030-11B1*
2002	V8, 8.1L, 496, G	EC10010-11B1*
2005-2001	V8, 8.1L, 496, E	EC10010-11B1*
2001	Any	EC10010-11B1*
1999	Any	EC10025-11B1*
1998-1997	V8, 6.5L, 395, F	EC10016-11B1*

EVAPORATIVE CANISTER PURGE SOLENOID VALVES

Chevrolet

1997-1996	V8, 5.7L, 350, R	HTV108
-----------	------------------	-------	--------

FILTER, EGR VACUUM REGULATOR SOLENOID VALVE

Chevrolet

1998-1997	V8, 6.0L, 366, P	HTF103
1998-1990	V8, 7.0L, 427, M	HTF103
1996-1992	V8, 7.0L, 427, M	HTF103
1989	Any	HTF103

GMC

1998-1997	V8, 6.0L, 366, P	HTF103
1998-1990	V8, 7.0L, 427, M	HTF103
1996-1992	V8, 7.0L, 427, M	HTF103
1989	Any	HTF103

IDLE AIR CONTROL VALVES

Chevrolet

2003-1998	V8, 5.7L, 350, R	CV10011-11B1
1997-1996	V8, 5.7L, 350, R	CV10011-11B1
1998-1997	V8, 6.0L, 366, P	CV10057-11B1
1998-1990	V8, 7.0L, 427, M	CV10057-11B1
1996-1992	V8, 7.0L, 427, M	CV10057-11B1
1996-1995	V8, 5.7L, 350, R	CV10033-11B1

GMC

2003-1996	V8, 5.7L, 350, R	CV10011-11B1
1998-1997	V8, 6.0L, 366, P	CV10057-11B1
1998-1990	V8, 7.0L, 427, M	CV10057-11B1
1996-1992	V8, 7.0L, 427, M	CV10057-11B1
1994-1993	V8, 5.7L, 350, R	CV10033-11B1

* For core criteria information, please see page 84.

* For core criteria information, please see page 84.



Year	Model/Engine	Description	Part Number
------	--------------	-------------	-------------

FEED PUMPS

Chevrolet			
2002-2001	V8, 8.1L, 496, E	FE0114-11B1
2002-2001	V8, 8.1L, 496, E	HFP922
2000-1999	V8, 7.4L, 454, D	FE0114-11B1
2000-1999	V8, 7.4L, 454, D	HFP922
1998-1997	Any	FE0114-11B1
1998	I6, 7.2L, L	Turbo	HFP921
1998	I6, 7.2L, L	Turbo	HFP922
1998-1997	I6, 7.1L	Turbo	HFP921
1998-1997	V8, 6.0L, 366, P	FE0112-11B1
1998-1997	V8, 6.0L, 366, P	HFP922
1998-1990	V8, 7.0L, 427, M	FE0112-11B1
1998-1990	V8, 7.0L, 427, M	HFP922
1997	I6, 6.6L, J	Turbo CAT 3116.....	HFP921
1997	V8, 6.5L, 395, F	Turbo	HFP921
1996-1992	V8, 7.0L, 427, M	FE0112-11B1
1995-1992	Any	FE0112-11B1
1992-1990	Any	FE0112-11B1
1990-1989	V8, 6.0L, 366, P	FE0112-11B1

GMC

2002-2001	V8, 8.1L, 496, E	FE0114-11B1
2002-2001	V8, 8.1L, 496, E	HFP922
2000-1999	V8, 7.4L, 454, D	FE0114-11B1
2000-1999	V8, 7.4L, 454, D	HFP922
1998	I6, 7.2L, L	Turbo	HFP921
1998-1997	Any	FE0114-11B1
1998-1997	V8, 6.0L, 366, P	FE0112-11B1
1998-1997	I6, 7.1L	Turbo	HFP921
1998-1997	V8, 6.0L, 366, P	HFP922
1998-1990	V8, 7.0L, 427, M	FE0112-11B1
1998-1990	V8, 7.0L, 427, M	HFP922
1997	V8, 6.5L, 395, F	Turbo	HFP921
1997	I6, 6.6L, J	Turbo CAT 3116.....	HFP921
1996-1992	V8, 7.0L, 427, M	FE0112-11B1
1995-1992	Any	FE0112-11B1
1992-1990	Any	FE0112-11B1
1990-1989	V8, 6.0L, 366, P	FE0112-11B1

FUEL STRAINERS

Chevrolet			
2002	Any	HTF104
2002-2001	V8, 8.1L, 496, E	HTF104

Year	Model/Engine	Description	Part Number
------	--------------	-------------	-------------

FUEL STRAINERS (cont.)

Chevrolet (cont.)

2002-2001	V8, 8.1L, 496, E	HTF105
2000	V8, 7.4L, 454, D	HTF104
2000-1999	V8, 7.4L, 454, D	HTF105
1998-1997	V8, 6.0L, 366, P	HTF105
1998-1990	V8, 7.0L, 427, M	HTF105
1997-1990	V8, 7.0L, 427, M	HTF104
1996-1992	V8, 7.0L, 427, M	HTF105
1990-1989	V8, 6.0L, 366, P	HTF104
1990-1989	V8, 6.0L, 366, P	HTF105
1988	V8, 6.0L, 366, P	HTF105

GMC

2002-2001	V8, 8.1L, 496, E	HTF104
2002-2001	V8, 8.1L, 496, E	HTF105
2002-2000	Any	HTF104
2000-1999	V8, 7.4L, 454, D	HTF104
2000-1999	V8, 7.4L, 454, D	HTF105
1998-1997	V8, 6.0L, 366, P	HTF105
1998-1990	V8, 7.0L, 427, M	HTF104
1998-1990	V8, 7.0L, 427, M	HTF105
1996-1992	V8, 7.0L, 427, M	HTF105
1990-1989	V8, 6.0L, 366, P	HTF104
1990-1988	V8, 6.0L, 366, P	HTF105

FUEL PRESSURE REGULATOR KITS

Chevrolet

1998-1990	V8, 7.0L, 427, M	FP10075-11B1
1998-1990	V8, 6.0L, 366, P	FP10075-11B1

TBI BASKET KITS

Chevrolet

1996-1992	V8, 7.0L, 427, M	7135-501
1998-1990	V8, 7.0L, 427, M	7135-501
1990	V8, 6.0L, 366, P	7135-501
1998-1997	V8, 6.0L, 366, P	7135-501

GMC

1996-1992	V8, 7.0L, 427, M	7135-501
1998-1997	V8, 6.0L, 366, P	7135-501



Year	Model/Engine	Description	Part Number
TBI BASKET KITS (cont.)			

GMC (cont.)

1990	V8, 6.0L, 366, P	7135-501
1998-1990	V8, 7.0L, 427, M	7135-501

TBI SEAL KIT

Chevrolet

1997	V8, 6.0L, 366, P	7135-236
------	------------------	-------	----------

FUEL PRESSURE SERVICE VALVE KITS

Chevrolet

2003-1998	V8, 5.7L, 350, R	HTV107
1997-1996	1997-1996	HTV107

GMC

2003-1996	V8, 5.7L, 350, R	HTV107
-----------	------------------	-------	--------

CRANKSHAFT POSITION SENSOR SEALS (O-RINGS)

Chevrolet

2003-1998	V8, 5.7L, 350, R	7135-502
2000-1999	V8, 7.4L, 454, D	7135-502
1997-1996	V8, 5.7L, 350, R	7135-502

GMC

2003-1996	V8, 5.7L, 350, R	7135-502
2000-1999	V8, 7.4L, 454, D	7135-502

EGR VALVE GASKETS

Chevrolet

1998-1997	V8, 6.0L, 366, P	7135-299
1998-1990	V8, 7.0L, 427, M	7135-299
1996-1992	V8, 7.0L, 427, M	7135-299
1996-1990	V8, 6.0L, 366, P	7135-299

GMC

1998-1997	V8, 6.0L, 366, P	7135-299
1998-1990	V8, 7.0L, 427, M	7135-299
1996-1992	V8, 7.0L, 427, M	7135-299

Year	Model/Engine	Description	Part Number
EGR VALVE GASKETS (cont.)			

GMC (cont.)

1995-1993	V8, 5.7L, 350, K	7135-299
1996-1990	V8, 6.0L, 366, P	7135-299

FUEL SENDER PADS

GMC

1996-1995	V8, 7.0L, 427, M	7135-508
1996-1995	V8, 6.5L, 395, F	Turbo.....	7135-508
1996-1995	V8, 6.0L, 366, P	7135-508
1996-1995	I6, 6.6L, J	Turbo CAT 3116.....	7135-508

FUEL FEED PIPE SEALS (O-RINGS)

Chevrolet

2007-2001	V8, 8.1L, 496, E	7135-504
2006-2003	Any	7135-504
2004	V8, 6.6L, 1	Turbo.....	7135-504
2002-1998	V6, 7.8L, 3	7135-504
2000-1999	V8, 7.4L, 454, D	7135-504
2000-1998	I6, 7.2L, L	7135-504
1998-1997	I6, 7.1L	7135-504
1998-1997	V8, 6.0L, 366, P	7135-504
1998-1990	V8, 7.0L, 427, M	7135-504
1996-1992	V8, 7.0L, 427, M	7135-504

GMC

2007-1999	V8, 8.1L, 496, E	7135-504
2006-2003	Any	7135-504
2004	V8, 6.6L, 1	Turbo.....	7135-504
2002-1998	V6, 7.8L, 3	Turbo.....	7135-504
2000-1998	I6, 7.2L, L	Turbo.....	7135-504
1998-1997	V8, 6.0L, 366, P	7135-504
1998-1997	I6, 7.1L	Turbo.....	7135-504
1998-1990	V8, 7.0L, 427, M	7135-504
1996-1992	V8, 7.0L, 427, M	7135-504

FUEL SENDER (O-RINGS)

Chevrolet

2007	V6, 7.8L, 3	Turbo.....	7135-506
2007	V8, 6.6L, 2	Turbo.....	7135-506

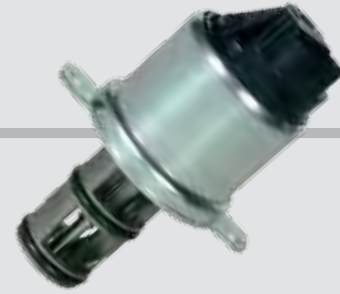

FUEL SENDER (O-RINGS) (cont.)

Year	Model/Engine	Description	Part Number
Chevrolet (cont.)			
2007-2005	V8, 8.1L, 496, E	7135-507
2007-2003	Any	7135-507
2007-2003	V6, 7.8L, 3	Turbo	7135-506
2006-2003	Any	7135-506
2006-2003	Any	7135-506
2003	V8, 8.1L, 496, E	7135-507
2002-1999	V6, 7.8L, 3	Turbo	7135-506
2002-1998	I6, 7.2L, L	Turbo	7135-248
2002-1998	V6, 7.8L, 3	Turbo	7135-248
2002-1998	I6, 7.2L, L	Turbo	7135-503
2002-1998	I6, 7.2L, L	Turbo	7135-506
2002-1998	V6, 7.8L, 3	Turbo	7135-503
2002-1998	I6, 7.2L, L	Turbo	7135-505
2002-1990	Any	7135-248
2002-1990	Any	7135-503
2002-1988	Any	7135-505
2001	V8, 8.1L, 496, E	7135-505
2000-1999	V8, 7.4L, 454, D	7135-507
1998	Any	7135-506
1998	Any	7135-507
1998	V8, 7.4L, 454, D	7135-503
1998-1997	I6, 7.1L	Turbo	7135-248
1998-1997	V8, 6.0L, 366, P	7135-248
1998-1997	I6, 6.6L, J	Turbo CAT 3116.....	7135-507
1998-1997	I6, 7.1L	Turbo	7135-503
1998-1997	I6, 7.1L	Turbo	7135-506
1998-1997	V8, 6.0L, 366, P	7135-503
1998-1997	V8, 6.0L, 366, P	7135-506
1997	I6, 6.6L, J	Turbo CAT 3116.....	7135-248
1997	Any	7135-506
1997	I6, 6.6L, J	Turbo CAT 3116.....	7135-503
1997	I6, 6.6L, J	Turbo CAT 3116.....	7135-506
1996-1992	Any	7135-503
1996-1992	V8, 7.0L, 427, M	7135-505
1995-1992	V8, 7.0L, 427, M	7135-248
1992	Any	7135-248
GMC			
2007	V8, 6.6L, 2	Turbo	7135-506
2007-2005	V8, 8.1L, 496, E	7135-507
2007-2003	V6, 7.8L, 3	Turbo	7135-506
2007-2003	Any	7135-507
2007-1999	V6, 7.8L, 3	Turbo	7135-506
2006-2004	Any	7135-506
2006-2003	Any	7135-506
2003	V8, 8.1L, 496, E	7135-507

FUEL SENDER (O-RINGS) (cont.)

Year	Model/Engine	Description	Part Number
GMC (cont.)			
2002-1998	V6, 7.8L	Turbo	7135-248
2002-1998	I6, 7.2L, L	Turbo	7135-248
2002-1998	V6, 7.8L, 3	Turbo	7135-503
2002-1998	I6, 7.2L, L	Turbo	7135-503
2002-1998	I6, 7.2L, L	Turbo	7135-506
2002-1998	I6, 7.2L, L	Turbo	7135-505
2002-1998	Any	7135-505
2002-1990	Any	7135-248
2002-1990	Any	7135-503
2001	V8, 8.1L, 496, E	7135-505
2000-1999	V8, 7.4L, 454, D	7135-507
1998	V8, 7.4L, 454, D	7135-503
1998	Any	7135-507
1998-1997	V8, 6.0L, 366, P	7135-248
1998-1997	I6, 7.1L	Turbo	7135-248
1998-1997	V8, 6.0L, 366, P	7135-503
1998-1997	I6, 7.1L	Turbo	7135-503
1998-1997	V8, 6.0L, 366, P	7135-506
1998-1997	I6, 7.1L	Turbo	7135-506
1998-1997	Any	7135-506
1998-1997	I6, 6.6L, J	Turbo CAT 3116.....	7135-507
1997	I6, 6.6L, J	Turbo CAT 3116.....	7135-248
1997	I6, 6.6L, J	Turbo CAT 3116.....	7135-503
1997	I6, 6.6L, J	Turbo CAT 3116.....	7135-506
1996-1992	Any	7135-503
1996-1992	V8, 7.0L, 427, M	7135-505
1995-1992	V8, 7.0L, 427, M	7135-248
1992	Any	7135-248

INJECTORS-MULTIPOINT

Chevrolet			
2003-1998	V8, 5.7L, 350, R	FJ10039-11B1
1997-1996	V8, 5.7L, 350, R	FJ10039-11B1
GMC			
2003-1996	V8, 5.7L, 350, R	FJ10039-11B1

INJECTORS

Chevrolet			
1998-1997	V8, 6.0L, 366, P	FJ10484-11B1
1998-1990	V8, 7.0L, 427, M	FJ10484-11B1

* For core criteria information, please see page 84.

* For core criteria information, please see page 84.



Year	Model/Engine	Description	Part Number
------	--------------	-------------	-------------

INJECTORS (cont.)			
Chevrolet (cont.)			
1998-1990	V8, 7.0L, 427, M	FJ10484-11B1
GMC			
1998-1997	V8, 6.0L, 366, P	FJ10484-11B1
1998-1990	V8, 7.0L, 427, M	FJ10484-11B1
1996-1992	V8, 7.0L, 427, M	FJ10484-11B1

COMPRESSOR*			
--------------------	--	--	--

Chevrolet			
1993-1990	V8, 7.0L, 427, M	CS0090-11B1
1990-1997	V8, 7.0L, 427, E	CS0092-11B1
GMC			
1993-1990	V8, 7.0L, 427, M	CS0090-11B1
1990-1997	V8, 5.7L, 350, K	CS0092-11B1

CONDENSER*			
-------------------	--	--	--

Chevrolet			
2002-2001	V8, 8.1L, 496, E	CF1173-11B1
2002-2001	I6, 6.6L, J	Turbo CAT 3116.....	CF1173-11B1
2002-1998	I6, 7.2L, L,	Turbo	CF1173-11B1
2000-1998	V8, 7.4L, 454, D	CF1173-11B1
2000-1998	V8, 7.4L, 454, B	CF1173-11B1
1998-1997	V8, 7.0L, 427, M	CF1173-11B1
1998-1997	V8, 6.0L, 366, P	CF1173-11B1
1998-1997	I6, 6.6L, J	Turbo CAT 3116.....	CF1173-11B1
1996-1995	I6, 6.6L, J	Turbo CAT 3116.....	CF10002-11B1
1993-1990	V8, 7.0L, 427, M	CF1147-11B1
1993-1990	V8, 6.0L, 366, P	CF1147-11B1
1993-1990	I6, 6.6L, J	Turbo CAT 3116.....	CF1147-11B1
1990	V8, 8.2L, 502, N	CF1147-11B1
GMC			
2002-2001	V8, 8.1L, 496, E	CF1173-11B1
2002-2001	I6, 6.6L, J	Turbo CAT 3116.....	CF1173-11B1
2002-1998	I6, 7.2L, L,	Turbo	CF1173-11B1
2000-1998	V8, 7.4L, 454, D	CF1173-11B1
2000-1998	V8, 7.4L, 454, B	CF1173-11B1
1998-1998	V8, 7.0L, 427, M	CF1173-11B1
1998-1997	V8, 6.0L, 366, P	CF1173-11B1
1998-1997	I6, 6.6L, J	Turbo CAT 3116.....	CF1173-11B1
1996-1995	I6, 6.6L, J	Turbo CAT 3116.....	CF10002-11B1

Year	Model/Engine	Description	Part Number
------	--------------	-------------	-------------

CONDENSER* (cont.)			
GMC (cont.)			
1993-1990	V8, 7.0L, 427, M	CF1147-11B1
1993-1990	V8, 6.0L, 366, P	CF1147-11B1
1993-1990	I6, 6.6L, J	Turbo CAT 3116.....	CF1147-11B1
1990	V8, 8.2L, 502,T	Turbo	CF1147-11B1

EVAPORATOR*			
--------------------	--	--	--

Chevrolet			
2002-2001	V8, 8.1L, 496, E	EP1011-11B1
2002-2001	I6, 7.2L, L	Turbo	EP1011-11B1
2002-2001	I6, 6.6L, J	Turbo CAT 3116.....	EP1011-11B1
1996-1994	V8, 7.0L, 427, M	EP1012-11B1
1996-1994	I6, 6.6L, J	Turbo CAT 3116.....	EP1012-11B1
1996-1994	I6, 6.6L, J	Turbo CAT 3116.....	EP1012-11B1
1995-1994	V8, 6.0L, 366, P	EP1012-11B1
1996	V8, 7.0L, 427, M	EP1012-11B1
1995	V8, 6.0L, 366, P	EP1012-11B1
GMC			
2002-2001	V8, 8.1L, 496, E	EP1011-11B1
2002-2001	I6, 7.2L, L	Turbo	EP1011-11B1
2002-2001	I6, 6.6L, J	Turbo CAT 3116.....	EP1011-11B1
1996-1994	V8, 7.0L, 427, M	EP1012-11B1
1996-1994	V8, 7.0L, 427, M	EP1012-11B1
1996-1994	V8, 6.0L, 366, P	EP1012-11B1
1996-1994	I6, 6.6L, J	Turbo CAT 3116.....	EP1012-11B1
1995-1994	I6, 6.6L, J	Turbo CAT 3116.....	EP1012-11B1

RADIATORS			
------------------	--	--	--

Chevrolet			
2002-2001	I6, 6.6L, J	Turbo CAT 3116.....	RA1021-11B1
2002-2001	V8, 8.1L, 496, E	RA1206-11B1
2002-2001	V8, 8.1L, 496, E	RA1207-11B1
2002-1998	I6, 7.2L, L	Turbo	RA1089-11B1
2002-1998	I6, 7.2L, L	Turbo	RA1090-11B1
2002-1998	V6, 7.8L, 3	Turbo	RA1098-11B1
2002-1998	I6, 7.2L, L	RA20013-11B1
2000-1999	V8, 7.4L, 454, D	RA1206-11B1
2000-1999	V8, 7.4L, 454, B	RA1207-11B1
2000-1998	I6, 7.2L, L	Turbo	RA1112-11B1
2000-1998	V8, 7.4L, 454, D	RA1207-11B1
1998	V8, 7.4L, D, 454	RA1098-11B1
1998	V8, 7.4L, 454, B	RA1206-11B1

* **Note:** Compressor, Condenser and Evaporator product lines are only available in bulk quantity-standard package size. Please refer to the pricing sheet for pack sizes.

* **Note:** Compressor, Condenser and Evaporator product lines are only available in bulk quantity-standard package size. Please refer to the pricing sheet for pack sizes.

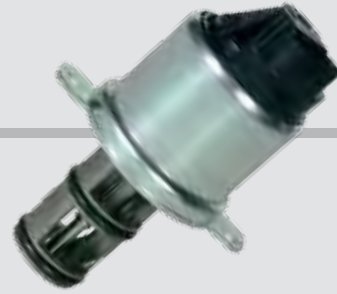

Year Model/Engine Description Part Number
RADIATORS (cont.)

Chevrolet (cont.)

1998-1997	I6, 6.6L, J	Turbo caT 3116	RA1089-11B1
1998-1997	I6, 7.1L	Turbo	RA1098-11B1
1998-1997	V8, 6.0L, 366, P	RA1113-11B1
1998-1997	V8, 7.0L, 427, M	RA1113-11B1
1998-1996	V8, 7.0L, 427, M	RA1088-11B1
1998-1996	I6, 6.6L, J	Turbo CAT 3116.....	RA1090-11B1
1998-1992	I6, 6.6L, J	Turbo CAT 3116.....	RA1021-11B1
1998-1991	I6, 6.6L, J	Turbo CAT 3116.....	RA1046-11B1
1997	V8, 6.0L, 366, P	RA1098-11B1
1997	I6, 6.6L, J	Turbo CAT 3116.....	RA20013-11B1
1997-1996	I6, 6.6L, J	Turbo CAT 3116.....	RA1092-11B1
1996	V8, 7.0L, 427, M	RA1056-11B1
1996	V8, 7.0L, 427, M	RA1091-11B1
1996-1990	V8, 7.0L, 427, M	RA1011-11B1
1995	V8, 6.0L, 366, P	RA1011-11B1
1995-1992	I6, 6.6L, J	Turbo CAT 3116.....	RA1050-11B1
1995-1992	V8, 6.0L, 366, P	RA1056-11B1
1995-1990	V8, 7.0L, 427, M	RA1043-11B1
1993	V8, 6.0L, 366, P	RA1011-11B1
1993	V8, 6.0L, 366, P	RA1043-11B1
1993-1990	V8, 6.0L, 366, P	RA1047-11B1
1992	V8, 7.0L, 427, M	RA1021-11B1
1991-1990	I6, 6.6L, J	Turbo CAT 3116.....	RA1021-11B1
1990	V8, 8.2L, 502, N	RA1021-11B1
1990	V8, 6.0L, 366, P	RA1043-11B1
1990-1988	V8, 8.2L, 502, T	Turbo	RA1021-11B1
1988	V8, 8.2L, 502, N	RA1021-11B1

GMC

2002-2001	I6, 6.6L, J	Turbo CAT 3116.....	RA1021-11B1
2002-2001	I6, 6.6L, J	Turbo CAT 3116.....	RA1089-11B1
2002-2001	V8, 8.1L, 496, E	RA1206-11B1
2002-2001	V8, 8.1L, 496, E	RA1207-11B1
2002-1998	I6, 7.2L, L	Turbo	RA1089-11B1
2002-1998	I6, 7.2L, L	Turbo	RA1090-11B1
2002-1998	V6, 7.8L, 3	Turbo	RA1098-11B1
2002-1998	I6, 7.2L, L	Turbo	RA1112-11B1
2002-1998	I6, 7.2L, L	RA20013-11B1
2000-1999	V8, 7.4L, 454, D	RA1206-11B1
2000-1999	V8, 7.4L, 454, B	RA1207-11B1
2000-1998	V8, 7.4L, 454, D	RA1207-11B1
1998	I6, 7.2L, L	Turbo	RA1021-11B1
1998	V8, 7.4L, 454, D	RA1098-11B1
1998	V8, 7.4L, 454, B	RA1206-11B1
1998-1997	I6, 6.6L, J	Turbo CAT 3116.....	RA1089-11B1
1998-1997	I6, 7.1L	Turbo	RA1098-11B1

Year Model/Engine Description Part Number
RADIATORS (cont.)

GMC (cont.)

1998-1997	V8, 6.0L, 366, P	RA1113-11B1
1998-1997	V8, 7.0L, 427, M	RA1113-11B1
1998-1996	V8, 7.0L, 427, M	RA1088-11B1
1998-1996	I6, 6.6L, J	Turbo CAT 3116.....	RA1090-11B1
1998-1991	I6, 6.6L, J	Turbo CAT 3116.....	RA1046-11B1
1998-1990	I6, 6.6L, J	Turbo CAT 3116.....	RA1021-11B1
1997	V8, 6.0L, 366, P	RA1098-11B1
1997	I6, 6.6L, J	Turbo CAT 3116.....	RA20013-11B1
1996	V8, 6.0L, 366, P	RA1011-11B1
1996	V8, 7.0L, 427, M	RA1091-11B1
1996-1993	V8, 7.0L, 427, M	RA1056-11B1
1996-1990	V8, 7.0L, 427, M	RA1011-11B1
1995	V8, 6.0L, 366, P	RA1043-11B1
1995-1992	I6, 6.6L, J	Turbo CAT 3116.....	RA1050-11B1
1995-1990	V8, 7.0L, 427, M	RA1043-11B1
1994	V8, 6.0L, 366, P	RA1011-11B1
1993-1990	V8, 6.0L, 366, P	RA1047-11B1
1992	V8, 7.0L, 427, M	RA1021-11B1
1992	V8, 6.0L, 366, P	RA1056-11B1
1990-1998	V8, 8.2L, 502, T	Turbo	RA1021-11B1
1990	V8, 6.0L, 366, P	RA1011-11B1

CRANKSHAFT POSITION SENSOR

Chevrolet

1998	V8, 5.7L, 350, R	SS10125-11B1
------	------------------	-------	--------------

GMC

1998	V8, 5.7L, 350, R	SS10125-11B1
------	------------------	-------	--------------

ENGINE COOLANT SENSOR

GMC

1994-1993	V8, 5.7L, 350, R	TS10078-11B1
-----------	------------------	-------	--------------

ENGINE COOLANT TEMPERATURE SENSORS

Chevrolet

2007-1990	Any	w/gauge	HTS134
2004-1998	V8, 5.7L, 350, R	w/gauge	HTS134
2000-1999	I6, 7.2L, L	Turbo w/gauge	HTS134
1998-1991	I6, 6.6L, J,	Turbo CAT 3116 w/gauge.....	HTS134

* For core criteria information, please see page 84.

* For core criteria information, please see page 84.

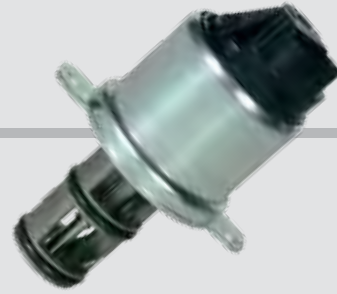

Year Model/Engine Description Part Number
ENGINE COOLANT TEMPERATURE SENSORS (cont.)

Chevrolet (cont.)

1998-1990	V8, 6.0L, 366, P	w/gauge	TS10075-11B1
1998-1990	V8, 7.0L, 427, M	w/gauge	TS10075-11B1
1997-1996	V8, 5.7L, 350, R	w/gauge	HTS133
1997-1995	V8, 5.7L, 350, R	w/gauge	TS10075-11B1
1996-1995	V8, 5.7L, 350, R	w/gauge	TS10075-11B1
1996-1992	Any	w/gauge	HTS134
1996-1992	I6, 6.6L, J	Turbo CAT 3116 w/gauge	HTS134
1990-1989	V8, 6.0L, 366, P	w/gauge	HTS134
1998	V8, 5.7L, 350, R	w/gauge	TS10075-11B1
1998	V8, 5.7L, 350, R	w/gauge	TS10075-11B1
1997	I6, 6.6L, J	Turbo CAT 3116 w/gauge	HTS134
1990	V8, 7.0L, 427, M	w/gauge	HTS134
1998-1997	V8, 6.0L, 366, P	w/gauge	TS10032-11B1
1998-1991	V8, 7.0L, 427, M	w/gauge	TS10032-11B1
1996-1992	V8, 7.0L, 427, M	w/gauge	TS10032-11B1

GMC

2007-1990	Any	w/gauge	HTS134
2004-1996	V8, 5.7L, 350, R	w/gauge	HTS133
2000-1999	I6, 7.2L, L	Turbo w/gauge	HTS134
1998-1997	V8, 5.7L, 350, R	w/gauge	TS10075-11B1
1998-1991	I6, 6.6L, J	Turbo CAT 3116 w/gauge	HTS134
1998-1990	V8, 7.0L, 427, M	w/gauge	TS10075-11B1
1998-1990	V8, 6.0L, 366, P	w/gauge	TS10075-11B1
1996-1992	I6, 6.6L, J	Turbo CAT 3116 w/gauge	HTS134
1996-1992	Any	w/gauge	HTS134
1994-1993	V8, 5.7L, 350, R	w/gauge	TS10075-11B1
1990-1989	V8, 6.0L, 366, P	w/gauge	HTS134
1997	I6, 6.6L, J	Turbo CAT 3116 w/gauge	HTS134
1990	V8, 7.0L, 427, M	w/gauge	HTS134
1998-1997	V8, 6.0L, 366, P	w/gauge	TS10032-11B1
1998-1991	V8, 7.0L, 427, M	w/gauge	TS10032-11B1
1996-1992	V8, 7.0L, 427, M	w/gauge	TS10032-11B1

FUEL SENDER SENSORS

Chevrolet

1998-1997	V8, 6.0L, 366, P		HTS136
1998-1990	V8, 7.0L, 427, M		HTS136
1998	I6, 7.2L, L	Turbo (OEM # 25094453)	HTS144
1998	I6, 7.2L, L	Turbo (OEM # 25094663)	HTS148
1998	I6, 7.2L, L	Turbo (OEM # 25164882)	HTS149
1998	I6, 7.2L, L	Turbo (OEM # 25165356)	HTS150
1997	I6, 6.6L, J	Turbo CAT 3116	HTS149

Year Model/Engine Description Part Number
FUEL SENDER SENSORS (cont.)

Chevrolet (cont.)

1998-1990	I6, 6.6L, J	Turbo CAT 3116 (OEM # 25094453)	HTS144
1998-1990	I6, 6.6L, J	Turbo CAT 3116 (OEM # 25094663)	HTS148
1998-1990	I6, 6.6L, J	Turbo CAT 3116 (OEM # 25164882)	HTS149
1998-1990	I6, 6.6L, J	Turbo CAT 3116 (OEM # 25165356)	HTS150
1998-1990	V8, 6.0L, 366, P	(OEM # 25174702)	HTS138
1998-1990	V8, 6.0L, 366, P	(OEM # 25028058)	HTS140
1998-1990	V8, 6.0L, 366, P	(OEM # 25094457)	HTS145
1998-1990	V8, 6.0L, 366, P	(OEM # 25094460)	HTS146
1998-1990	V8, 6.0L, 366, P	(OEM # 25094641)	HTS147
1998-1990	V8, 7.0L, 427, M	(OEM # 25174702)	HTS138
1998-1990	V8, 7.0L, 427, M	(OEM # 25028058)	HTS140
1998-1990	V8, 7.0L, 427, M	(OEM # 25094457)	HTS145
1998-1990	V8, 7.0L, 427, M	(OEM # 25094460)	HTS146
1998-1990	V8, 7.0L, 427, M	(OEM # 25094641)	HTS147
1996-1993	V8, 6.0L, 366, P		HTS143
1996-1993	V8, 7.0L, 427, M		HTS143
1996-1991	I6, 6.6L, J	Turbo CAT 3116	HTS142
1992-1991	V8, 6.0L, 366, P	(OEM # 25174702)	HTS138
1992-1991	V8, 6.0L, 366, P		HTS139
1992-1991	V8, 7.0L, 427, M		HTS139

GMC

1998-1997	V8, 6.0L, 366, P		HTS136
1998-1990	V8, 7.0L, 427, M		HTS136
1998	I6, 7.2L, L	Turbo (OEM # 25094453)	HTS144
1998	I6, 7.2L, L	Turbo (OEM # 25094663)	HTS148
1998	I6, 7.2L, L	(OEM # 25165356)	HTS150
1998-1990	V8, 7.0L, 427, M		HTS138
1998-1990	V8, 6.0L, 366, P		HTS138
1998-1990	V8, 7.0L, 427, M		HTS140
1998-1990	V8, 6.0L, 366, P		HTS140
1998-1990	I6, 6.6L, J	Turbo CAT 3116 (OEM # 25094453)	HTS144
1998-1990	V8, 7.0L, 427, M		HTS145
1998-1990	V8, 6.0L, 366, P		HTS145
1998-1990	V8, 7.0L, 427, M		HTS146
1998-1990	V8, 6.0L, 366, P		HTS146
1998-1990	V8, 7.0L, 427, M		HTS147
1998-1990	V8, 6.0L, 366, P		HTS147
1998-1990	I6, 6.6L, J	Turbo CAT 3116 (OEM # 25094663)	HTS148
1998-1990	I6, 6.6L, J	Turbo CAT 3116 (OEM # 25164882)	HTS149
1998-1990	I6, 6.6L, J	Turbo CAT 3116 (OEM # 25165356)	HTS150
1997	V8, 6.0L, 366, P		HTS140
1997	I6, 6.6L, J	Turbo CAT 3116	HTS149
1996-1993	V8, 7.0L, 427, M		HTS143
1996-1993	V8, 6.0L, 366, P		HTS143
1996-1991	I6, 6.6L, J	Turbo CAT 3116	HTS142

* For core criteria information, please see page 84.

* For core criteria information, please see page 84.

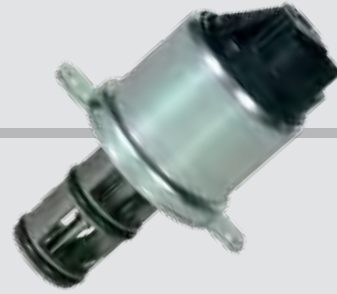

FUEL SENDER SENSORS (cont.)

Year	Model/Engine	Description	Part Number
GMC (cont.)			
1992-1991	V8, 7.0L, 427, M	HTS139
1992-1991	V8, 6.0L, 366, P	HTS139

KNOCK SENSORS

Year	Model/Engine	Description	Part Number
Chevrolet			
2003-1998	V8, 5.7L, 350, R	AS10015-11B1
1997-1996	V8, 5.7L, 350, R	AS10015-11B1
1996-1992	V8, 7.0L, 427, M	AS10015-11B1
1996-1990	V8, 7.0L, 427, M	AS10015-11B1
GMC			
2003-1996	V8, 5.7L, 350, R	AS10015-11B1
1996-1992	V8, 7.0L, 427, M	AS10015-11B1
1996-1990	V8, 7.0L, 427, M	AS10015-11B1

MAP SENSOR

Year	Model/Engine	Description	Part Number
Chevrolet			
2007-2001	V8, 8.1L, 496, E	PS10000-11B1
2002-2001	V8, 5.7L, 350, R	PS10000-11B1
2000-1999	V8, 7.4L, 454, D	PS10000-11B1
1998-1997	V8, 6.0L, 366, P	PS10075-11B1
1998-1990	V8, 6.0L, 366, P	PS10075-11B1
1998-1990	V8, 7.0L, 427, M	PS10075-11B1
1997-1996	V8, 5.7L, 350, R	PS10000-11B1
1996-1991	V8, 6.0L, 366, P	PS10075-11B1
1996-1991	V8, 7.0L, 427, M	PS10075-11B1
GMC			
2007-2001	V8, 8.1L, 496, E	PS10000-11B1
2002-2001	V8, 5.7L, 350, R	PS10000-11B1
2000-1999	V8, 7.4L, 454, D	PS10000-11B1
1998-1997	V8, 6.0L, 366, P	PS10075-11B1
1998-1997	V8, 6.0L, 366, P	PS10075-11B1
1998-1990	V8, 7.0L, 427, M	PS10075-11B1
1997-1996	V8, 5.7L, 350, R	PS10000-11B1
1996-1991	V8, 7.0L, 427, M	PS10075-11B1
1994-1991	V8, 6.0L, 366, P	PS10075-11B1

THROTTLE POSITION SENSORS

Year	Model/Engine	Description	Part Number
Chevrolet			
2003-1998	V8, 5.7L, 350, R	MS10382-11B1
1998-1997	V8, 6.0L, 366, P	MS10425-11B1
1997-1996	V8, 5.7L, 350, R	SS10382-11B1
1998-1990	V8, 7.0L, 427, M	SS10425-11B1
1996-1992	V8, 7.0L, 427, M	SS10425-11B1
1990-1989	V8, 6.0L, 366, B	SS10425-11B1
1994	Any	SS10425-11B1
1991	Any	SS10425-11B1
1984	Any	SS10425-11B1
GMC			
2003-1996	V8, 5.7L, 350, R	SS10382-11B1
1998-1997	V8, 6.0L, 366, P	SS10425-11B1
1998-1990	V8, 7.0L, 427, M	SS10425-11B1
1996-1992	V8, 7.0L, 427, M	SS10425-11B1
1994-1993	Any	SS10425-11B1
1990-1989	V8, 6.0L, 366, B	SS10425-11B1
1991	Any	SS10425-11B1
1984	Any	SS10425-11B1

VEHICLE SPEED SENSORS

Year	Model/Engine	Description	Part Number
Chevrolet			
2002-2000	V6, 7.8L, 3	Turbo	HTS135
2002-1998	I6, 7.2L, L	Turbo	HTS135
2000-1999	V8, 7.4L, 454, D	HTS135
1999-1997	Any	HTS135
1998-1997	V8, 7.0L, 427, M	HTS135
1998-1994	I6, 6.6L, J	Turbo CAT 3116.....	HTS135
1996-1995	V8, 7.0L, 427, M	HTS135
1995-1992	Any	HTS135
1995-1990	V8, 7.0L, 427, M	HTS135
1994-1990	V8, 6.0L, 366, P	HTS135
1997	V8, 6.0L, 366, P	HTS135
1997	V8, 6.5L, 395, F	Turbo	HTS135
GMC			
2002-2000	V6, 7.8L, 3	Turbo	HTS135
2002-1998	I6, 7.2L, L	Turbo	HTS135
2000-1999	V8, 7.4L, 454, D	HTS135
1999-1997	Any	HTS135
1998-1997	V8, 7.0L, 427, M	HTS135
1998-1994	I6, 6.6L, J	Turbo CAT 3116.....	HTS135
1996-1995	V8, 7.0L, 427, M	HTS135

* For core criteria information, please see page 84.

* For core criteria information, please see page 84.



Year	Model/Engine	Description	Part Number
VEHICLE SPEED SENSORS (cont.)			
GMC (cont.)			
1995-1992	Any	HTS135
1995-1990	V8, 7.0L, 427, M	HTS135
1994-1990	V8, 6.0L, 366, P	HTS135
1997	V8, 6.5L, 395, F	Turbo	HTS135
1997	V8, 6.0L, 366, P	HTS135

WATER PUMPS			
Chevrolet			
1996-1995	V8, 5.7L, 350, R	WP8553
GMC			
1998-1997	V8, 5.7L, 350, R	WP8553



MACK

FEED PUMP 58
 NOZZLES..... 58



Nozzle

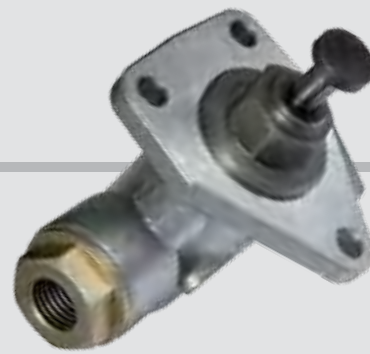

Year	Model/Engine	Description	Part Number
FEED PUMP			
	E7-EN7	HFP937

Year	Model/Engine	Description	Part Number
NOZZLES			
	E673	5628919
	E707	5628919
	E711	5628919
	E6-200	11.0L.....	6980005
	E6-200	11.0L.....	L116PBA
	E6-250	11.0L.....	6980005
	E6-250	11.0L.....	L116PBA
	E6-315	11.0L.....	6980005
	E6-315	11.0L.....	L116PBA
	E6-315R	11.0L.....	6980005
	E6-315R	11.0L.....	L116PBA
	E6-350 2VH	11.0L.....	L107PBA
	E6-350 4VH	11.0L.....	L118PBA
	E6-350 4VH	11.0L.....	L106PBA
	E7 Series	L093PBB
	E7 Series	L098PBB
	E7 Series	L099PBB
	E7 Series	L100PBB
	E7-250	12.0L.....	L102PBA
	E7-300	L094PBA
	E7-300 4VH	12.0L.....	L107PBA
	E7-300 4VH	12.0L.....	L118PBA
	E7-300A 4VH	12.0L.....	L107PBA
	E7-350	12.0L.....	L094PBA
	E7-350 4VH	12.0L.....	L107PBA
	E7-350 4VH	12.0L.....	L094PBA
	E7-400	12.0L.....	L094PBA
	E7-400	12.0L.....	L107PBA
	E7-400 4VH	12.0L.....	L107PBA
	E9-300L 2VH	16.0L.....	L111PBA
	E9-450	16.0L.....	L111PBA
	E9-450 4VH	16.0L.....	L111PBA
	E9-450 4VH	16.0L.....	L107PBA
	E9-500	16.0L.....	L111PBA
	E9-500 4VH	16.0L.....	L111PBA
	E9-500 4VH	16.0L.....	L107PBA
	EC6-350 4VH	11.0L.....	L106PBA
	EE6-200	6980005
	EE6-260	6980004
	EE6-350	L116PBA
	EE9-502 4VH	16.0L.....	L107PBA
	EM6-225	6980005
	EM6-225L 4VH	11.0L.....	L118PBA

Year	Model/Engine	Description	Part Number
NOZZLES (cont.)			
	EM6-237	11.0L.....	L105PBA
	EM6-237	11.0L.....	L108PBA
	EM6-237	11.0L.....	L116PBA
	EM6-237 2VH	11.0L.....	L108PBA
	EM6-250	6980005
	EM6-250	L116PBA
	EM6-250L 4VH	11.0L.....	L118PBA
	EM6-250L 4VH	L106PBA
	EM6-250R	6980005
	EM6-250R	L116PBA
	EM6-275L 2VH	11.0L.....	L107PBA
	EM6-275L 4VH	11.0L.....	L118PBA
	EM6-285	6980005
	EM6-285 2VH	6980005
	EM6-285 2VH	L116PBA
	EM6-300 4VH	L107PBA
	EM7 Series	L092PBB
	EM7-250	12.0L.....	L107PBA
	EM7-250	12.0L.....	L102PBA
	EM7-250L 4VH	12.0L.....	L107PBA
	EM7-250L 4VH	12.0L.....	L118PBA
	EM7-275	12.0L.....	L107PBA
	EM7-275	12.0L.....	L102PBA
	EM7-300L	12.0L.....	L107PBA
	EM7-300L 4VH	12.0L.....	L118PBA
	EM7-300L 4VH	12.0L.....	L107PBA
	EM7-300L 4VH	12.0L.....	L107PBA
	EMC6-250L 2VH	11.0L.....	L118PBA
	EMC6-300L 2VH	11.0L.....	L118PBA
	EME6-237	11.0L.....	6980005
	EME6-250	11.0L.....	L116PBA
	EME6-250 CMCAC	11.0L.....	L116PBA
	EME6-250R	11.0L.....	L116PBA
	EME6-250R CMCAC	11.0L.....	L116PBA
	EME6-285	11.0L.....	6980005
	EME6-285R	11.0L.....	6980005
	EME6-300R CMCAC	11.0L.....	L116PBA
	EME6-300R SCAC	11.0L.....	L116PBA
	EN6-260	L116PBA
	END 673E	10.8L.....	5628919
	END 711	10.8L.....	5628919
	ENDT 675	10.8L.....	5628919
	ENDT 675C	10.8L.....	6980005
	ENDT 676	11.0L.....	6980004
	ENDT 676	11.0L.....	6980005
	ENDT 676	11.0L.....	6980004
	ES9-502	11.0L.....	L111PBA
	ET 673	11.0L.....	5628919



Year	Model/Engine	Description	Part Number
------	--------------	-------------	-------------

NOZZLES (cont.)

	ET 673A	11.0L	5628919
	ET 673C	11.0L	5628919
	ET 673E	11.0L	5628919
	ET 675	11.0L	5628919
	ET 675Z	11.0L	6980005
	ETA 676	11.0L Maxidyne.....	6980004
	ETA 676 Z	11.0L	6980004
	ETA 676B	11.0L	6980004
	ETA 676B	11.0L	6980005
	ETAY 673A	6980004
	ETAY 673A	6980005
	ETAZ 673A	11.0L	6980004
	ETAZ 673A	11.0L	6980005
	ETAZ 673C	11.0L	6980004
	ETAZ 673C	11.0L	6980005
	ETAZ 676	11.0L	6980004
	ETAZ 676	11.0L	6980005
	ETSZ 673A	11.0L	6980005
	ETSZ 676	11.0L	6980005
	ETY 673E	6980005
	ETY 675	6980005
	ETZ 673C	6980005
	ETZ 673E	6980005
	ETZ 675	6980005
	ETZ 675	L105PBA
	736BG343P6	L101PBB
	736GB343P8	L115PBB
	114GC29	L119SBA



MERCEDES-BENZ

Year	Model/Engine	Description	Part Number
------	--------------	-------------	-------------

INJECTORS

	BR500 engine	B02906B
	BR500 engine	B02907B
	BR900 engine	B03003B
	BR900 engine	B03005B



Injector

* For core criteria information, please see page 84.

* For core criteria information, please see page 84.



EGR VALVE	64
FEED PUMPS	64
IPR O-RING KITS	64
INJECTOR O-RING KITS	64
INJECTOR/GLOW PLUG HARNESSSES	64
GASKET KITS	64
SHIM KITS	64
SERVICE KITS	65
FUEL INJECTORS	65
GLOW PLUGS	65
GLOW PLUG CONTROLLERS	65
ENGINE OIL PUMPS	65
HIGH PRESSURE OIL PUMPS	65
INJECTION PRESSURE REGULATORS	65
AMBIENT AIR TEMPERATURE SENSOR	66
CAM POSITION SENSORS	66
CONTROL SENSOR	66
CRANKSHAFT POSITION SENSOR	66
ENGINE COOLANT TEMPERATURE SENSORS	66
ENGINE OIL PRESSURE SENSORS	66

ENGINE OIL TEMPERATURE SENSORS	66
EXHAUST BACK PRESSURE SENSORS	66
EXHAUST BACK PRESSURE REGULATOR	67
INJECTION CONTROL PRESSURE SENSORS	67
INTAKE AIR TEMPERATURE SENSOR	67
MANIFOLD AIR TEMPERATURE SENSOR	67
SMART REMOTE ACTUATOR	67
WATER PUMP	67



Feed Pump

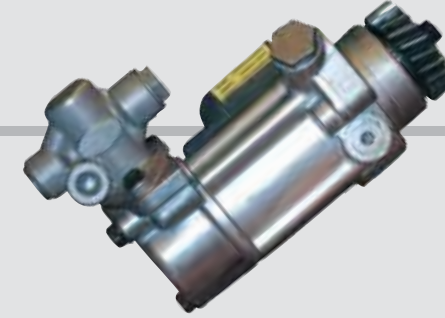

Year	Model/Engine	Description	Part Number
EGR VALVE			
2005-2003	VT365	HTV103
FEED PUMPS			
	DT444E	HFP917
	DT466E/I530E	HFP925
	DTA530/DTA466	HFP940
	DTA530/DTA466	HFP946
IPR O-RING KITS			
	DT444E	HTK100
	DT466E	HTK100
	DT530E	HTK100
INJECTOR O-RING KITS			
	DT444E	One kit per injector	HTP109
	DT466E/I530E	One kit per injector	HTP109
INJECTOR/GLOW PLUG HARNESSSES			
	DT466	HTK105
	DT530	HTK105
	DT444E	Engine s/n 661895 and up	HTP119
	DT444E	Engine s/n 00500 – 661894	HTP110
GASKET KITS			
	DT466E/I530E	Oil Pan Gasket	7135-296
	DT444E	Valve Cover Gasket Engine s/n 661895 and up	7135-285
	DT444E	Valve Cover Gasket Engine s/n 00500 – 661894	7135-284
	DT466	7135-536
	DT530	7135-536
SHIM KITS			
	DT466E/I530E	For Installation of Camshaft Position Sensor	HTK101

Year	Model/Engine	Description	Part Number
SERVICE KITS			
	DT466E/I530E	Washer for installation of Feed Pump	HTK102
	DT466E/I530E	Screw for installation of Feed Pump	HTK103
FUEL INJECTORS			
	VT365, VT275	Engines built 9/22/03 and up	EX636692*
	VT365	Engines built before 9/21/03	EX633089*
	DT466	EX638489*
GLOW PLUGS			
	VT365	Glow Plug (later version)	HDS806
	DT444E	Glow Plug	HDS310
GLOW PLUG CONTROLLERS			
	VT365	Glow Plug Relay	HDC912
	DT444E	Glow Plug Relay	HDC908
ENGINE OIL PUMPS			
	DT466E/I530E	HTP116
	I530E	HTP117
HIGH PRESSURE OIL PUMPS			
	VT365	Engine s/n 6,344,943 and up	HTP122
	VT365	Engine s/n 0 – 6,344,942	HTP123*
	DT444E	Engine s/n 843990 and up	HTP108*
	DT444E	Engine s/n 661895 – 843989	HTP107*
	DT444E	Engine s/n 216544 – 661894	HTP105*
	DT444E	Engine s/n 00500 – 216543	HTP104*
	DT466E/I530E	w/Feed Pump	HTP114*
INJECTION PRESSURE REGULATORS			
	VT365	Engine s/n 6,344,943 and up	HTV102
	VT365	Engine s/n 0 – 6,344,942	HTV110
	DT444E	Engine s/n 216544 and up	HTF101
	DT444E	Engine s/n 00500 – 216543	HTF100
	DT466E/I530E	Engine s/n 998706 and up	HTF101
	DT466E/I530E	Engine s/n 0 – 998705	HTF100

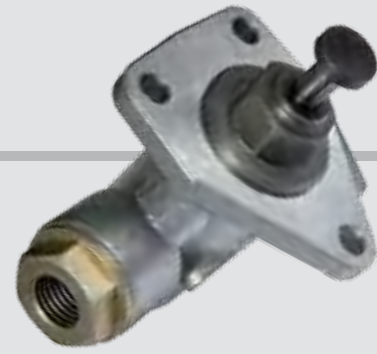

Year Model/Engine Description Part Number

AMBIENT AIR TEMPERATURE SENSOR

DT466E/I530E located in the inlet pipe..... HTS117

CAM POSITION SENSORS

VT365 HTS126
DT444E Engine s/n 375549 and up HTS101
DT444E HTS101 Alternative..... HTS101G
DT444E Engine s/n 0 – 375548 HTS100
DT466E/I530E Installation kit HTK101 required..... HTS116

CONTROL SENSOR

DT444E HTS124
DT466E/I530E HTS124

CRANKSHAFT POSITION SENSOR

VT365 HTS132

ENGINE COOLANT TEMPERATURE SENSORS

VT365 HTS125
DT444E Engine s/n 0 – 375548 HTS117
DT466E/I530E HTS117

ENGINE OIL PRESSURE SENSORS

VT365 HTS129
DT466E/I530E w/o consolidated engine controller (cec)..... HTS104
DT466E/I530E w/consolidated engine controller (cec)..... HTS121

ENGINE OIL TEMPERATURE SENSORS

VT365 HTS125
DT444E Engine s/n 0 – 375548 HTS117
DT466E/I530E HTS117

EXHAUST BACK PRESSURE SENSORS

DT444E Engine s/n 375549 and up HTS105
DT444E Engine s/n 0 – 375548 HTS104

Year Model/Engine Description Part Number

EXHAUST BACK PRESSURE REGULATOR

DT444E Engine s/n 0 – 375548 HTS106

INJECTION CONTROL PRESSURE SENSORS

VT365 HTS127
DT444E Engine s/n 375549 and up HTS102
DT444E Engine s/n 0 – 375548 HTS103
DT466E/I530E Engine s/n 1134350 and up HTS123
DT466E/I530E Engine s/n 0 – 1134350 HTS103
DT570 HTS151
DT466 HTS151

INTAKE AIR TEMPERATURE SENSOR

VT365 HTS131

MANIFOLD AIR TEMPERATURE SENSOR

VT365 HTS128

SMART REMOTE ACTUATOR (SRA)

DT466/DT530 SRA fitted w/Borg Warner Turbo EX727311*

WATER PUMP

DT466E/I530E EXWP8182*

* For core criteria information, please see page 84.

* For core criteria information, please see page 84.



SMART REMOTE ACTUATOR (SRA)

Delphi's "smart" remote actuator (SRA) is a highly accurate device with integrated electronics that include a pulse width-modulation (PWM) control interface with the option of a controlled area network (CAN) communication. It has an aluminum body, direct current (DC) brushless motor, steel gears, ball bearings, and a pigtail electrical wiring harness. The durable unit offers the potential for unpowered default positioning.



PROGRAM HIGHLIGHTS

- Remanufactured in our ISO 9001:2000 certified facility
- Every remanufactured SRA is functionally tested for:
 - o Torque position resolution
 - o Response time
 - o Full travel
- Tested and assembled to meet OE specifications

THE DELPHI ADVANTAGE

- Delphi OE.
- Replacement of critical components as needed including new circuit board, new wiring harness, new seals, fasteners and motors.
- One Year Warranty

FEATURES

BENEFITS

Integrated electronics, with dynamic precision position sensing	– Provides improved EGR flow control with enhanced accuracy resolution
DC brushless motor	– High torque and durability
Aluminum body, steel gears	– High durability
Compact unit with a single connection	– Greater mounting and packaging flexibility, which allows for actuation of high-temperature devices

Did You Know?

- **Typical Application** The smart remote actuator provides improved exhaust gas recirculation (EGR) dynamic flow control. It can also provide high accuracy resolution of variable geometry turbocharger (VGT) vane control. Its durability, flexible mounting options, and adaptability allow for the actuation of various high-temperature gas controls and other powertrain devices.
- **Performance Advantages.** The sensitivity and precision of the integrated electronics in the smart remote actuator can significantly improve the dynamic flow control in EGR systems or offer improved control, speed, and precision for VGT systems, as compared to pneumatic and hydraulic actuators. The device uses integrated technology for accurate position control, high actuation torques, and flexible mounting options. It is also easily adaptable to a variety of other devices requiring rotary input. Its single-point electrical connection to the engine management system allows greater mounting, packaging, and interface flexibility, and it provides plug-and-play simplicity. Delphi designs and supplies complete diesel engine management systems, including injection units and electronics. Delphi engine management systems deliver immediate results for drivers and operators, while helping to lower emissions and improve economy.



VOLVO

REMANUFACTURED ELECTRONIC UNIT INJECTORS

Year	Model/Engine	Description	Part Number
	D12 12.1L	EX631002*
	D12 12.1L	EX631003*
	D12 12.1L	EX631004*
	D12 12.1L	EX631006*
	D12 12.1L	EX631007*
	D12 12.1L	EX631008*



Electronic Unit Injector

* For core criteria information, please see page 84.

VOLVO



OEM	Delphi
1109	HDS308
1110	HDS306
1111	HDS310
1113	HDS802
1117	HDS806
41181	WP7123
42349	WP8721
44018	WP8585
44042	WP4925
44056	WP4913
44099	WP8550
44100	WP4937
45000	WP5885
45007	WP5903
217605	6760301
217609	6703801
217619	LJCK01101
217620	LJCK01102
217624	6703803
217625	6703802
218045	621015
218463	HDS307
218464	HDS305
218465	HDS309
220215	HTS104
226461	HTV109
226690	HTV104
226693	HTV105
227074	HTS113
227077	HTS112
238988	EX633089
238989	EX636692
641008	NLVP5041
641024	NLVP4342
641025	NLVP3450
641300	NLVP4013
1101111	RM1013
1101293	RM1004
1101629	RM1004
1101633	RM1013
1113266	SX1124
1113267	SX1104
1113269	SX1124
1113270	SX1104
1113295	SX1124
1113296	SX1104
1136456	CS0090-11B1
1136458	CS0092-11B1
1547287	EX631003
1547909	EX631002
1612488	EC10072-11B1
1997254	HTS119
1997258	HTV108
3096043	RA1011-11B1
3096190	CF1147-11B1
3169521	EX631007
3284014	HFP701
3284073	HFP701
3284074	HFP701

OEM	Delphi
3802004	WP7123
3904374	HFP274
3917334	HFP700
3917997	HFP701
3917998	HFP701
3917999	HFP701
3918000	HFP701
3918076	HFP702
3919093	6980081
3921550	HFP700
3921682	SX3691
3923084	7135-294
3925709	HFP916
3925856	HFP700
3926034	HFP700
3926814	6980084
3927153	HFP916
3930134	HFP916
3930135	HFP700
3930201	HFP701
3930202	HFP701
3932224	HFP916
3932225	HFP700
3932226	HFP701
3933252	HFP916
3933253	HFP700
3933254	HFP701
3933255	HFP701
3936316	HFP700
3936318	HFP701
3936319	HFP701
3938367	HFP923
3938435	HFP923
3964404	EX631004
3969705	7135-297
3990082	HFP923
3990105	HFP923
4089602	HFP943
4111482	TS10034
4428221	SX3691
4429103	NLVP4013
4429374	HFP274
4429404	WP7123
4638643	TS10197-11B1
4638765	EXLVP2756
4720314	TS10131-11B1
4720315	TS10133-11B1
4741012	SX3717
4746706	EXLVP2756
4761979	HFP916
4793110	SX3717
4886919	EC10249-11B1
4932707	HFP923
4944712	HFP701
4988747	HFP916
4988749	HFP701
5226374	TS10019-11B1
5233160	RM1601
5233199	RM1601

OEM	Delphi
5233608	RM3979
5233660	RM3979
5233733	RM4011
5234033	RM4011
5234902	SS10441-11B1
5613673	HDS308
5613680	HDS305
5613738	HDS309
5613826	HDS308
5613939	HDS800
5614017	HDS801
5614220	HDS307
6442199	HFP906
7002371	HTP110
8112557	EX631002
8112660	EX631003
8113092	EX631004
8113180	EX631006
8113411	EX631008
8113837	EX631007
8170966	EX631006
8170998	EX631008
8547194	HAC101
8547195	HAC102
8547236	HAC103
8547237	HAC104
8547543	HAC105
8547547	HAC106
8547548	HAC107
8547551	HAC108
8547552	HAC109
8547553	HAC110
8547561	HAC111
8547563	HAC112
8547577	HAC113
8547581	HAC114
8547626	HAC115
8993146	TS10138-11B1
9350899	HTS112
10096181	TS10032-11B1
10129565	7135-501
10137639	HTV106
10159525	HTF103
10183974	6703803
10233972	6703802
10233973	6703803
10456288	AS10015-11B1
10456607	SS10125-11B1
10459027	RM20000
10459028	RM20001
10459047	RM20002
10459233	RM20003
10459256	RM20004
10461081	SX20000
10461082	SX20001
10463002	RM1013
10463110	RM1004
10463210	RM20005
10463300	RM20006

OEM	Delphi
10463339	RM1013
10463393	RM1009
10463417	RM1009
10463424	RM1004
10463425	RM1055
10463529	RM20007
10463940	RM1024
10464438	RM1385
10464453	RM1386
10465013	SX1124
10465014	SX1104
10465053	SX1124
10465054	SX1104
10465160	RM20008
10465167	SX20002
10465320	SX20003
10465321	SX20004
10465322	SX20005
10465375	SX20006
10476885	7135-502
10479994	RM1013
10479997	RM1013
10480086	RM1009
10480094	RM1004
10480097	RM1009
10480099	RM1055
10480130	RM1036
10480133	RM1360
10480167	RM1024
10480168	RM1039
12015288	HDC901
12052153	HDC904
12088520	HDC904
12088560	HDC907
12135176	HDC907
12146312	TS10075-11B1
12160244	TS10072-11B1
12182099	HDC904
12200411	EC10010-11B1
12215049	HTS113
12219931	PS10074-11B1
12337972	7135-299
12456231	WP4913
12496078	HDC904
12496472	HDC907
12514269	WP8550
12532528	WP8553
12534772	WP4925
12556263	HTS133
12557046	SS10126-11B1
12581565	EC10030-11B1
12582605	EC10031-11B1
12586242	EC10035-11B1
12586243	EC10036-11B1
12589462	EC10037-11B1
12589463	EC10038-11B1
14050546	WP8550
14059057	6704001
14063606	6703801

OEM	Delphi
14088123	7135-503
15018546	HFP953
15161174	HFP955
15326386	TS10075-11B1
15575722	HDC903
15614669	7135-248
15633466	WP4937
15661825	6703802
15684629	HTS134
15754298	HFP922
15969349	HTS135
16006835	PS10074-11B1
16017460	PS10075-11B1
16131231	HTS136
16137039	PS10075-11B1
16168625	EC10089-11B1
16183977	EC10055-11B1
16187556	PS10000-11B1
16197427	EC10014-11B1
16208546	EC10025-11B1
16216588	EC10035-11B1
16229684	EC10020-11B1
16244210	EC10025-11B1
16254539	PS10000-11B1
16263494	EC10027-11B1
17063994	EG10052-11B1
17084729	EG10065-11B1
17084815	EG10073-11B1
17084818	EG10074-11B1
17084830	EG10075-11B1
17091432	FJ10039-11B1
17106681	SS10425-11B1
17111846	EG10127-11B1
17112202	FJ10484-11B1
17112203	CV10057-11B1
17112408	7135-236
17112486	7135-229
17112715	PS10075-11B1
17112759	HTV107
17113203	FP10075-11B1
17113209	CV10011-11B1
17113221	FJ10058-11B1
17113405	EG10026-11B1
17113414	EG10052-11B1
17113431	EG10065-11B1
17113438	EG10073-11B1
17113439	EG10074-11B1
17113440	EG10075-11B1
17113618	EG10026-11B1
17123852	SS10382-11B1
19013199	RM1013
19030013	RM1013
19030024	RM1024
19030329	RM1360
21020103	PS10075-11B1
22514722	7135-504
22514724	HDC900
22515965	7135-505
22531535	HDC902

OEM	Delphi
23500138	WP4937
25004553	7135-508
25027014	7135-506
25027400	HTS139
25028058	HTS140
25028874	HTS142
25029685	HTS143
25037332	TS10078-11B1
25037334	TS10090-11B1
25055457	HTF104
25055460	HTF105
25094453	HTS144
25094457	HTS145
25094460	HTS146
25094641	HTS147
25094663	HTS148
25115224	HFP905
25116503	HFP909
25117340	HFP921
25121207	HFP954
25163212	HDS309
25163472	FE0112-11B1
25163473	FE0114-11B1
25164882	HTS149
25165116	ES10039-11B1
25165356	HTS150
25166292	7135-507
25166816	HTS137
25168651	HDS309
25174702	HTS138
25312191	ES10008-11B1
25339320	HTS114
25339321	HTS109
25527077	CV10033-11B1
33004281	TS10019-11B1
52450950	HAC116
52452179	RA1021-11B1
52454595	HAC117
52457248	RA1043-11B1
52457549	RA1046-11B1
52457675	RA1047-11B1
52458196	HAC118
52458537	RA1050-11B1
52458839	HAC119
52460930	RA1056-11B1
52461239	HAC120
52461240	HAC121
52461241	HAC122
52461242	HAC123
52461243	HAC124
52461246	HAC125
52464036	EP1011-11B1
52464049	EP1012-11B1
52464174	CF10002-11B1
52469619	RA1088-11B1
52469620	RA1089-11B1
52469621	RA1090-11B1
52469622	RA1091-11B1
52469623	RA1092-11B1



OEM	Delphi
52470016	HAC134
52470229	RA1098-11B1
52470237	RA20013-11B1
52471174	RA1111-11B1
52471175	RA1112-11B1
52471180	RA1113-11B1
52477032	CF1173-11B1
52487492	RA1206-11B1
52487493	RA1207-11B1
56004815	TS10031
56027272	SS10177-11B1
56027273	SS10178-11B1
56027871	SS10128-11B1
56040788	EC10588-11B1
56040797	EC10584-11B1
88961136	EC10055-11B1
88963802	EC10072-11B1
88999187	EC10089-11B1
94011694	7135-295
97180655	HTS115
97209343	HTP120
97209548	SX3469
97216136	WP8721
97224993	HTS108
97225608	HDC911
97225635	HTS111
97226202	HDS802
97226648	HDC910
97251974	HDS803
97253673	HTS107
97254004	7135-294
97256734	HTF102
97261720	HTS110
97288505	NLVP3450
97288827	HTV109
97371491	HDC911
97384931	HTS110
161370390	PS10075-11B1
440008174	HFP925
8972093431	HTP120
8972256082	HDC911
8972262022	HDS802
8972266481	HDC910
8972519740	HDS803
8972536730	HTS107
8972540040	7135-294
E7PZ-10346-E	RM1520
E7PZ-10346-L	RM1520
D3VY-10346-A	RM1509
1803175C1	HDC905
E7SF-10300-FA	RM1520
E9PF-10346-FA	RM1588
F4TZ-11002-B	SX3496
F81Z-10346-EA	RM1563
F81Z-9C407-AA	HFP920
F81Z-9C407-AC	HFP920
5011852AA	TS10135-11B1
E6SF-10300-AA	RM1520
E6SF-10300-BA	RM1520

OEM	Delphi
E6TF-10300-BA	RM1520
E6TF-10346-AA	RM1520
E6TZ-10346-A	RM1520
E6ZF-10346-BA	RM1520
E6ZZ-10346-B	RM1520
E7AF-10300-CA	RM1520
E7PF-10300-GA	RM1520
E7PF-10346-UA	RM1520
E7SF-10300-KA	RM1520
E7ZF-10300-DA	RM1520
E8FZ-9B989-A	SS10423
E8PF-10300-BA	RM1520
E8PF-10346-AA	RM1520
F0UU-10300-AA	RM1596
F1TZ-9F593-B	621015
F2TZ-93989-B	SS10450-11B1
F37U-10300-AA	RM1535
F3UU-10300-AF	RM1535
F3VY-12A647-A	TS10201-11B1
F5UU-10300-AA	RM1535
F5UZ-10346-CA	RM3749
F6UU-10300-FA	FM1535
F6UZ-10346-VA	RM1535
F81U-10300-GA	RM1564
E3TF-11000-AA	SX1103
E5TF-11000-AA	SX3456
E7TZ-9B989-A	SS10428-11B1
E8PZ-10346-A	RM1520
E8TE-9F593-A	FJ10202-11B1
E8TF-11000-AA	SX3456
F0PZ-10346-D	RM1509
F3UZ-10346-A	RM1535
F4SZ-9B989-A	SS10387-11B1
F4TZ-11002A	SX3461
004 171 433 0	6980005
006 171 433 0	6980004
010 171 433 0	6980005
033 175 433 0	6980081
078 175 433 0	6980084
318 271 433 0	5628919
3C3Z-9A543-AARM	HTP122
4C3Z-9A543-AARM	HTP123
E3TZ-11002-B	SX1103
E5TZ-11002-B	SX3456
E7PF-10346-LA	RM1588
E8TZ-11002-A	SX3456
F0TZ-12B533-A	HDC906
F2AZ-9B989-A	SS10449-11B1
XW4U-10300-CC	SX3468
XW4U-10300-CE	SX3468
114GC 222P2	6980005
E6TF-10300-CA	RM1520
E6UF-10300-AA	RM1520
E6ZF-10300-CA	RM1520
E7AF-10300-BA	RM1520
E7AF-10300-DA	RM1520
E9UF-10300-AA	RM1596
F0TU-10300-BA	RM1595
F2TU-10300-AF	RM1535

OEM	Delphi
F3UU-10300-AE	RM1535
F6UU-10300-EA	RM1535
F81U-10300-EB	RM1563
F81Z-10346-GA	RM1564
1C2Z-11002AA	SX3468
1C3Z-11002AA	SX3467
E63F-10300-AA	RM1520
E6AF-10300-AA	RM1520
E6AF-10300-AF	RM1520
E6AF-10300-BA	RM1520
F3TU-11000-AA	SX3456
F5TU-11000-AA	SX3461
F5TU-11000-AB	SX3461
F5UU-10300-CA	RM3749
F6SZ-12A697-A	TS10098-11B1
F6UU-10300-CA	RM1535
E4TZ-9E527-B	6760301
E8TZ-9E527-A	6760301
F2AZ-12A648-A	TS10001-11B1
F4PU-11000-AA	SX3496
F5AZ-12A697-A	TS10023-11B1
2591022C91	HTP123
E1AZ-12A648-A	TS10001-11B1
XW4Z-10346-CC	SX3468
0 432 191 360	B02906B
0 432 191 363	B02907B
0 433 171 036	L105PBA
0 433 171 057	L116PBA
0 433 171 058	L108PBA
0 433 171 063	L116PBA
0 433 171 173	L111PBA
0 433 171 187	L106PBA
0 433 175 014	L107PBA
0 433 175 020	L112PBA
0 433 175 036	L102PBA
0 433 175 037	L094PBA
0 433 175 062	L093PBB
0 433 175 063	L101PBB
0 433 175 064	L115PBB
0 433 175 089	L113PBA
0 433 175 090	L114PBA
0 433 175 096	L103PBA
0 433 270 999	L119SBA
0 440 003 178	HFP926
0 440 003 228	HFP927
0 440 003 239	HFP926
0 440 008 040	HFP934
0 440 008 086	HFP937
0 440 008 134	HFP946
0 440 008 141	HFP940
10480388W	RM1385
114GC 222	6980005
114GC 29	L119SBA
114GC 310	5628919
114GC 314	6980004
114GC 316	8547626
114GC 318	8547626
114GC 318P2	L116PBA
114GC 318P9	L106PBA

OEM	Delphi
114GC 319	L108PBA
114GC 321P2	L107PBA
114GC 322	L111PBA
114GC 323	L112PBA
114GC 324AP3	L101PBB
114GC 324AP4	L093PBB
114GC 324AP5	L115PBB
114GC 324AP6	L103PBA
114GC 325	L094PBA
114GC 325P3	L102PBA
114GC 325P4	L113PBA
114GC 325P6	L114PBA
11G	HDS309
12G	HDS308
13G	HDS800
15G	HDS801
1697269C91	HTS124
1803175C1	HDC905
1804211C2	HDS305
1807329C91	HTS116
1807329C92	HTS116
1807339C92	HTS116
1807369C2	HTS121
1807455C92	HTK105
1807917C2	HDS307
1810491C1	HTK103
1811059C91	HDC906
1811059C92	HDC906
1812818C92	HTS103
1814320C1	HTS117
1819649C1	HDS307
1820697C2	HDS310
1822326C92	HTP116
1822390C92	HTP117
1824415C91	HFP917
1824415C92	HFP917
1824415C93	HFP917
1824982C91	HTF100
1825602C91	7135-536
1825681C95	HTP114
1825806C92	HTK100
1826583C91	HTK101
1826587C1	7135-296
1826634C94	HDC908
1828345C91	HTS132
1830606C94	EXWP8182
1830669C91	HTS123
1831646C1	HDC908
1833564C92	HTP109
1835985C92	HTS126
1836412C91	HTF101
1836537C91	HTS125
1836539C91	HTS128
1839415C91	HTS129
1839416C91	HTS131
1839437C95	HTV110
1840078C1	HTS120
1840903C91	HDC912
1841217C91	HTF101
1842722C91	HTP114

OEM	Delphi
1843089C95	EX633089
1843286C2	HDS805
1843481C94	EX633089
1843481C95	EX633089
1844751C2	EX636692
1845150C92	EX636692
1845428C9.01	HTS127
1845536C91	HTS151
1845879C91	EX633089
1846296C91	HTV103
1846490C91	HTV104
1846491C91	HTV105
1846692C92	EX636692
1847620C92	EX727311
1848489C91	EX638489
1876735C91	HTS101G
1876735C91	HTS101
1882919C91	HTP122
1C2Z-11002AA	SX3468
1C2Z12A650AHB	EC10627-11B1
1C2Z12A650AHD	EC10627-11B1
1C2Z12A650AHE	EC10627-11B1
1C3Z-11002AA	SX3467
1C3Z12A650ABC	EC10319-11B1
1C3Z12A650AFC	EC10804-11B1
1C3Z12A650YB	EC10625-11B1
216-89	EC10055-11B1
218-11787	EC10027-11B1
218-11798	EC10020-11B1
2C2Z12A650AHB	EC10621-11B1
2C3Z12A650AE	EC10631-11B1
2C3Z12A650CE	EC10628-11B1
2C3Z12A650DF	EC10310-11B1
2C3Z12A650GE	EC10630-11B1
2C3Z-9C968-BA	HTF100
3087557PX	EX637557
3087560PX	EX637560
314G6227PS	HFP937
3411753PX	EX631753
3411756PX	EX631756
3411758PX	EX631758
3411760PX	EX631760
3411761PX	EX631761
3411763PX	EX631763
3411764PX	EX631764
3411766PX	EX631766
3411767PX	EX631767
3652542PX	EX632542
3C3Z-12A697-AA	HTS128
3C3Z-6C315-AA	HTS132
3C3Z-9C968-AA	HTV110
3C3Z-9E527-AE	EX633089
3C3Z-9F452-AC	HTV103
4897243AA	EXLVP2756
4C2Z2A451AA	NLVP3731
4C3Z-12A342-AA	HDS806
4C3Z-12B533-AA	HDC912
4C3Z-9E527-AA	EX636692
4C3Z-9F383-AB	HTS127
4C3Z-9F452-A	HTV105

OEM	Delphi
4C3Z-9J460-A	HTS105
5011796AA	EXLVP2756
5011796AB	EXLVP2756
5011852AA	TS10135-11B1
5012209AA	HFP916
5012209AB	HFP916
5012376AA	HFP274
5014228AA	HFP923
5015553AA	HFP923
5019734AA	EXLVP2756
5080885AA	HFP923
5093135AA	HFP943
5093135AB	HFP943
5114434AA	HFP943
5278334AB	EC10246-11B1
56028740AB	EC10529-11B1
56040034AA	EC10569-11B1
56040035AA	EC10570-11B1
56040138AA	EC10568-11B1
56040139AA	EC10571-11B1
56040197AA	EC10470-11B1
56040198AA	EC10471-11B1
56040199AA	EC10472-11B1
56040200AA	EC10469-11B1
56040414AC	EC10577-11B1
56040415AC	EC10578-11B1
56040416AC	EC10579-11B1
56040417AC	EC10576-11B1
56040451AA	EC10581-11B1
56040453AA	EC10582-11B1
56040454AA	EC10580-11B1
56040477AA	EC10528-11B1
56040506AD	EC10583-11B1
56046353AA	EC10537-11B1
56046354AA	EC10538-11B1
56046355AA	EC10539-11B1
56046356AA	EC10536-11B1
5C3Z-9C968-CA	HTV102
5C3Z-9F452-AA	HTV104
62G	HDS802
691273C1	HTK102
8C3Z 12K073-A	HTS126
8G	HDS305
9 440 080 008	HFP941
9 440 080 013	HFP942
9 440 080 022	HFP948
9G	HDS306
A005 017 36 21	B02906B
A005 017 66 21	B03003B
A005 017 69 21	B02907B
A005 017 88 21	B03003B
A006 017 38 21	B03003B
A006 017 46 21	B02906B
A006 017 53 21	B02907B
A006 017 63 21	B03005B
AR145	HDC904
BRPV-1	NLVP3731
CSS1103	HTS101
CSS512	HTS100
CSS9153	HTS114



OEM	Delphi
CSS9177	HTS132
D22F-10300-AA	RM1507
D22F-10300-AB	RM1507
D22F-10300-BB	RM1507
D22F-10346-BB	RM1508
D2AF-10300-EA	RM1507
D2FZ-10346-B	RM1507
D2OF-10300-AA	RM1507
D2OF-10300-GA	RM1507
D2OF-10346-B	RM1507
D2OF-10346-BA	RM1507
D32F-10300-AA	RM1507
D30F-10300-AA	RM1507
D3VF-10300-AA	RM1508
D3VF-10300-AB	RM1508
D3VF-10300-BA	RM1508
D3VF-10346-BA	RM1508
D42F-10300-CA	RM1507
D40F-10300-EA	RM1507
D40F-10346-DA	RM1507
D40Z-10346-D	RM1507
D4TF-10300-DA	RM1508
D4TZ-10346-A	RM1508
D4ZF-10300-AA	RM1507
D52F-10300-BA	RM1507
D5DF-10300-AA	RM1507
D50F-10300-AA	RM1507
D50F-10300-BA	RM1508
D50F-10300-CA	RM1507
D5UF-10300-AA	RM1508
D5ZF-10300-BA	RM1509
D6UF-10300-AA	RM1508
D7DF-10300-AA	RM1507
D7EF-10300-AA	RM1507
D7EF-10300-BA	RM1507
D7EF-10300-CA	RM1507
D7EF-10300-DA	RM1507
D70F-10300-AA	RM1507
D70F-10300-BA	RM1509
D70F-10300-CA	RM1507
D70F-10300-DA	RM1507
D70F-10300-EA	RM1507
D70F-10346-A	RM1507
D70F-10346-AA	RM1507
D70F-10346-B	RM1507
D70F-10346-BA	RM1507
D7UF-10300-AA	RM1507
D7UF-10300-BA	RM1508
D7UF-10300-CA	RM1508
D7VF-10346-AA	RM1508
D7VZ-10346-A	RM1509
D7ZF-10300-BA	RM1508
D7ZF-10300-CA	RM1508
D7ZF-10300-DA	RM1507
D7ZF-10300-EA	RM1507
D8BF-10300-DA	RM1507
D8BF-10346-CA	RM1507
D8BF-10346-DA	RM1507
D8VF-10300-BA	RM1508

OEM	Delphi
D8VF-10300-CA	RM1507
D8VF-10346-BA	RM1509
D8VF-10346-CA	RM1507
D8ZF-10300-FA	RM1507
D9AF-10300-CA	RM1507
D9BF-10300-AA	RM1509
D9BZ-10346-C	RM1507
D9DF-10300-AA	RM1507
D90F-10300-AA	RM1507
D9TF-10300-AA	RM1507
D9UF-10300-EA	RM1507
D9UF-10300-FA	RM1508
D9UF-10300-GA	RM1509
D9VY-10346-C	RM1507
D9VY-10346-D	RM1509
D9ZF-10300-BA	RM1507
E1AF-10300-BA	RM1508
E1AF-10300-DA	RM1507
E1AZ-12A648-A	TS10001-11B1
E1BF-10300-BA	RM1507
E1BF-10300-CA	RM1509
E1BF-10346-CA	RM1507
E1BZ-10346-A	RM1507
E1NF-10300-AA	RM1508
E1TF-10300-BA	RM1507
E1UF-10300-AA	RM1508
E1VF-10346-AA	RM1509
E1VZ-10346-A	RM1509
E1ZF-10300-EA	RM1507
E37F-10300-AA	RM1507
E3TF-10300-AB	RM1507
E3TF-11000-AA	SX1103
E3TZ-11002-B	SX1103
E3TZ-8501-D	WP8585
E3TZ-9350-B	HFP907
E3TZ-9A444-A	HDC905
E3UF-10300-AB	RM1508
E3ZF-10300-AA	RM1507
E4LF-10300-CA	RM1507
E4TZ-8501-C	WP8585
E5HN-9350-AA	HFP948
E5LF-10300-AA	RM1507
E5TF-11000-AA	SX3456
E5TZ-11002-B	SX3456
E5VF-10300-AA	RM1509
E5ZF-10300-AA	RM1507
E63F-10300-AA	RM1520
E6AF-10300-AA	RM1520
E6AF-10300-AF	RM1520
E6AF-10300-BA	RM1520
E6DF-10300-CA	RM1507
E6DF-10300-FA	RM1507
E6DF-10300-FB	RM1507
E6DF-10300-HA	RM1507
E6DF-10346-DA	RM1508
E6DZ-10346-D	RM1507
E6SF-10300-AA	RM1520
E6SF-10300-BA	RM1520
E6TF-10300-BA	RM1520

OEM	Delphi
E6TF-10300-CA	RM1520
E6TF-10346-AA	RM1520
E6TZ-10346-A	RM1520
E6UF-10300-AA	RM1520
E6ZF-10300-CA	RM1520
E6ZF-10346-BA	RM1520
E6ZZ-10346-B	RM1520
E7AF-10300-BA	RM1520
E7AF-10300-CA	RM1520
E7AF-10300-DA	RM1520
E7DF-10300-EA	RM1509
E7DF-10300-EB	RM1509
E7DF-10300-FA	RM1508
E7FZ-9F479-A	PS10062-11B1
E7PF-10300-GA	RM1520
E7PF-10346-LA	RM1588
E7PF-10346-PA	RM1507
E7PF-10346-RA	RM1509
E7PF-10346-UA	RM1520
E7PZ-10346-A	RM1509
E7PZ-10346-B	RM1507
E7PZ-10346-E	RM1520
E7PZ-10346-L	RM1520
E7SF-10300-FA	RM1520
E7SF-10300-KA	RM1520
E7TF-10300-GA	RM1508
E7TF-10300-JA	RM1508
E7TF-10300-NA	RM1508
E7TZ-9B989-A	SS10428-11B1
E7VF-10300-AA	RM1509
E7VF-10300-BA	RM1509
E7ZF-10300-DA	RM1520
E8FZ-9B989-A	SS10423
E8PF-10300-BA	RM1520
E8PF-10346-AA	RM1520
E8PZ-10346-A	RM1520
E8TE-9F593-A	FJ10202-11B1
E8TE-9F593-B1C	FJ10202-11B1
E8TF-11000-AA	SX3456
E8TZ-11002-A	SX3456
E9PF-10346-FA	RM1588
E9TF-10300-AA	RM1507
E9TZ-8501-B	WP8585
E9UF-10300-AA	RM1596
F0AU-10300-AA	RM1508
F0LU-10300-AA	RM1508
F0PU-10346-JA	RM1507
F0PU-10346-KA	RM1508
F0PZ-10346-C	RM1509
F0TU-10300-AA	RM1507
F0TU-10300-BA	RM1595
F0UU-10300-AA	RM1596
F0UU-10300-BA	RM1508
F1TE-9F593-D1A	FJ10109-11B1
F1TE-9F593-D5A	FJ10109-11B1
F2AZ-12A648-A	TS10001-11B1
F2AZ-9B989-A	SS10449-11B1
F2TU-10300-AF	RM1535
F2TZ-93989-B	SS10450-11B1

OEM	Delphi
F2TZ-9E527-A	LJCK01101
F37U-10300-AA	RM1535
F3TU-11000-AA	SX3456
F3TZ-9E527-A	LJCK01102
F3UU-10300-AE	RM1535
F3UU-10300-AF	RM1535
F3UU-9K044-AA	HFP917
F3UZ-10346-A	RM1535
F3VY-12A647-A	TS10201-11B1
F4PU-11000-AA	SX3496
F4SZ-9B989-A	SS10387-11B1
F4TF12B565AA	EC10358-11B1
F4TZ-11002A	SX3461
F4TZ-11002-B	SX3496
F4TZ-12A342-A	HDS310
F4TZ-2A451-A	NLVP5041
F4TZ-6584-A	7135-284
F4TZ-8501-A	WP5903
F4TZ-8501-ARM	WP5903
F4TZ-9A543-BRM	HTP104
F4TZ-9C968-C	HTF100
F4TZ-9C968-CB	HTF100
F4TZ-9D930-K	HTP110
F4TZ-9F838-A	HTS103
F4TZ-9J460-A	HTS104
F5AZ-12A697-A	TS10023-11B1
F5TU-11000-AA	SX3461
F5TU-11000-AB	SX3461
F5TZ12A650BTD	EC10289-11B1
F5TZ12A650BTE	EC10289-11B1
F5TZ12A650FG	EC10289-11B1
F5TZ-6C673-A	HTS106
F5TZ-8501-ARM	WP5903
F5TZ-8501-BRM	WP5903
F5TZ-8501-CRM	WP5903
F5TZ-9A543-AA	HTP104
F5UU-10300-AA	RM1535
F5UU-10300-CA	RM3749
F5UZ-10346-CA	RM3749
F6SZ-12A697-A	TS10098-11B1
F6TZ12A650AYE	EC10276-11B1
F6TZ12A650AYF	EC10276-11B1
F6TZ-12K073-A	HTS100
F6TZ-2A451-AA	NLVP4342
F6TZ-8501-AA	WP5885
F6TZ-9350-A	HFP917
F6TZ-9A543-ARM	HTP105
F6TZ-9C977-AN	HTK100
F6TZ-9F838-A	HTS102

OEM	Delphi
F6UU-10300-CA	RM1535
F6UU-10300-EA	RM1535
F6UZ-10346-VA	RM1535
F7TZ-12B533-AA	HDC908
F7TZ-12B533-CA	HDC908
F7TZ-12K073-A	HTS101G
F7TZ-12K073-A	HTS101
F7TZ-8501-BRM	WP5885
F7TZ-8501-CRM	WP5885
F7TZ-9J460-BA	HTS105
F81U-10300-EB	RM1563
F81U-10300-GA	RM1564
F81Z-10346-EA	RM1563
F81Z-10346-GA	RM1564
F81Z12A650JE	EC10615-11B1
F81Z12A650MD	EC10618-11B1
F81Z12A650PF	EC10616-11B1
F81Z-12B533-AC	HDC908
F81Z-6584-AA	7135-285
F81Z-8501-ARM	WP5885
F81Z-8501-BRM	WP5903
F81Z-8501-CRM	WP5885
F81Z-9278-AA	HTS129
F81Z-9A543-BRM	HTP107
F81Z-9A543-CRM	HTP108
F81Z-9C968-AA	HTF101
F81Z-9C968-AB	HTF101
F81Z-9D930-AB	HTP119
F8TZ-9229-AA	HTP109
F8UZ12A650AFF	EC10617-11B1
F8UZ12A650AGE	EC10619-11B1
F8UZ12A650AGF	EC10619-11B1
F8UZ12A650AJA	EC10614-11B1
GPC101	HDC900
GPC102	HDC903
GPC103	HDC905
GPC104	HDC906
GPC106	HDC907
GPR111	HDC908
M60278	HFP907
M60281	HFP906
M61067	HFP917
M73060	HFP274
M73098	HFP701
M73104	HFP916
OP6222	HTS129
P74001	HFP905
P74143	HFP921
P74213	HFP923

OEM	Delphi
P74214	HFP955
P74221	HFP920
P74222	HFP922
P76110	HFP943
R5234785	EX634785
R5234795	EX634795
R5234865	EX634865
R5234870	EX634870
R5234935	EX634935
R5234940	EX634940
R5234945	EX634945
R5234970	EX634970
R5235550	EX635550
R5235575	EX635575
R5235580	EX635580
R5235600	EX635600
R5235605	EX635605
R5235695	EX635695
R5235915	EX635915
R5236347	EX636347
R5236977	EX636977
R5236978	EX636978
R5236980	EX636980
R5236981	EX626981
R5237045	EX637045
R5237099	EX637099
R5237466	EX637466
R5237635	EX637635
R5237650	EX637650
XC2Z12A650ANF	EC10624-11B1
XC3Z12A650BG	EC10334-11B1
XC3Z12A650DCB	EC10626-11B1
XC3Z12A650DG	EC10623-11B1
XC3Z12A650KG	EC10620-11B1
XU2Z12A650CG	EC10622-11B1
XU2Z12A650SA	EC10622-11B1
XW4U-10300-CC	SX3468
XW4U-10300-CD	SX3468
XW4U-10300-CE	SX3468
XW4Z-10346-CC	SX3468
ZD11	HDS310
ZD1A	HDS305
ZD9	HDS307

NOTE: Interchange by using a competitor part number is not positive identification. Certain competitor part number interchanges are included at popular request, but absolute correlation is not possible. No responsibility is assumed by manufacturer or publisher for consequential or other damages which may arise from reliance on a competitor part number to make identification.

DISCLAIMER OF WARRANTY –The information contained herein has been obtained from reliable sources and is accurate insofar as is ascertainable. However, no warranty is either expressed or implied as to the accuracy of this catalog and no responsibility is assumed by the publisher for any damages. The acceptance of this catalog is conditional to the acceptance of this disclaimer of warranty.



Delphi	OEM
621015	218045
621015	F1TZ-9F593-B
5628919	433271318
5628919	114GC310
6703801	217609
6703801	14063606
6703802	217625
6703802	10233972
6703802	15661825
6703803	217624
6703803	10183974
6703803	10233973
6704001	14059057
6760301	217605
6760301	E4TZ-9E527-B
6760301	E8TZ-9E527-A
6980004	433171006
6980004	114GC314
6980005	433171004
6980005	433171010
6980005	114GC222P2
6980005	114GC222
6980081	3919093
6980081	433175033
6980084	3926814
6980084	433175078
7135-229	17112486
7135-236	17112408
7135-248	15614669
7135-284	F4TZ-6584-A
7135-285	F81Z-6584-AA
7135-294	3923084
7135-294	97254004
7135-294	8972540040
7135-295	94011694
7135-296	1826587C1
7135-297	3969705
7135-299	12337972
7135-501	10129565
7135-502	10476885
7135-503	14088123
7135-504	22514722
7135-505	22515965
7135-506	25027014
7135-507	25166292
7135-508	25004553
7135-536	1825602C91
AS10015-11B1	10456288
B02906B	432191360
B02906B	A0050173621
B02906B	A0060174621
B02907B	432191363
B02907B	A0050176921
B02907B	A0060175321
B03003B	A0050176621
B03003B	A0050178821
B03003B	A0060173821
B03005B	A0060176321
CF10002-11B1	52464174

Delphi	OEM
CF1147-11B1	3096190
CF1173-11B1	52477032
CS0090-11B1	1136456
CS0092-11B1	1136458
CV10011-11B1	17113209
CV10033-11B1	25527077
CV10057-11B1	17112203
EC10010-11B1	12200411
EC10014-11B1	16197427
EC10016-11B1	16216588
EC10020-11B1	16229684
EC10020-11B1	218-11798
EC10025-11B1	16208546
EC10025-11B1	16244210
EC10027-11B1	16263494
EC10027-11B1	218-11787
EC10030-11B1	12581565
EC10031-11B1	12582605
EC10035-11B1	12586242
EC10036-11B1	12586243
EC10037-11B1	12589462
EC10038-11B1	12589463
EC10055-11B1	16183977
EC10055-11B1	216-89
EC10055-11B1	88961136
EC10072-11B1	1612488
EC10072-11B1	88963802
EC10089-11B1	16168625
EC10089-11B1	88999187
EC10246-11B1	5278334AB
EC10249-11B1	4886919
EC10276-11B1	F6TZ12A650AYE
EC10276-11B1	F6TZ12A650AYF
EC10289-11B1	F5TZ12A650BTD
EC10289-11B1	F5TZ12A650BTE
EC10289-11B1	F5TZ12A650FG
EC10310-11B1	2C3Z12A650DF
EC10319-11B1	1C3Z12A650ABC
EC10334-11B1	XC3Z12A650BG
EC10358-11B1	F4TF12B565AA
EC10469-11B1	56040200AA
EC10470-11B1	56040197AA
EC10471-11B1	56040198AA
EC10472-11B1	56040199AA
EC10528-11B1	56040477AA
EC10529-11B1	56028740AB
EC10536-11B1	56046356AA
EC10537-11B1	56046353AA
EC10538-11B1	56046354AA
EC10539-11B1	56046355AA
EC10568-11B1	56040138AA
EC10569-11B1	56040034AA
EC10570-11B1	56040035AA
EC10571-11B1	56040139AA
EC10576-11B1	56040417AC
EC10577-11B1	56040414AC
EC10578-11B1	56040415AC
EC10579-11B1	56040416AC
EC10580-11B1	56040454AA

Delphi	OEM
EC10581-11B1	56040451AA
EC10582-11B1	56040453AA
EC10583-11B1	56040506AD
EC10584-11B1	56040797
EC10588-11B1	56040788
EC10614-11B1	F8UZ12A650AJA
EC10615-11B1	F81Z12A650JE
EC10616-11B1	F81Z12A650PF
EC10617-11B1	F8UZ12A650AFF
EC10618-11B1	F81Z12A650MD
EC10619-11B1	F8UZ12A650AGE
EC10619-11B1	F8UZ12A650AGF
EC10620-11B1	XC3Z12A650KG
EC10621-11B1	2C2Z12A650AHB
EC10622-11B1	XU2Z12A650CG
EC10622-11B1	XU2Z12A650SA
EC10623-11B1	XC3Z12A650DG
EC10624-11B1	XC2Z12A650ANF
EC10625-11B1	1C3Z12A650YB
EC10626-11B1	XC3Z12A650DCB
EC10627-11B1	1C2Z12A650AHB
EC10627-11B1	1C2Z12A650AHD
EC10627-11B1	1C2Z12A650AHE
EC10628-11B1	2C3Z12A650CE
EC10630-11B1	2C3Z12A650GE
EC10631-11B1	2C3Z12A650AE
EC10804-11B1	1C3Z12A650AFC
EG10026-11B1	17113405
EG10026-11B1	17113618
EG10052-11B1	17063994
EG10052-11B1	17113414
EG10065-11B1	17084729
EG10065-11B1	17113431
EG10073-11B1	17084815
EG10073-11B1	17113438
EG10074-11B1	17084818
EG10074-11B1	17113439
EG10075-11B1	17084830
EG10075-11B1	17113440
EG10127-11B1	17111846
EP1011-11B1	52464036
EP1012-11B1	52464049
ES10008-11B1	25312191
ES10039-11B1	25165116
EX626981	R5236981
EX631002	8112557
EX631002	1547909
EX631003	8112660
EX631003	1547287
EX631004	8113092
EX631004	3964404
EX631006	8113180
EX631006	8170966
EX631007	8113837
EX631007	3169521
EX631008	8113411
EX631008	8170998
EX631753	3411753PX
EX631760	3411760PX

Delphi	OEM
EX631761	3411761PX
EX631763	3411763PX
EX631766	3411766PX
EX631767	3411767PX
EX632542	3652542PX
EX633089	1843089C95
EX633089	1843481C94
EX633089	1843481C95
EX633089	1845879C91
EX633089	238988
EX633089	3C3Z-9E527-AE
EX634785	R5234785
EX634795	R5234795
EX634865	R5234865
EX634870	R5234870
EX634935	R5234935
EX634940	R5234940
EX634945	R5234945
EX634970	R5234970
EX635550	R5235550
EX635575	R5235575
EX635580	R5235580
EX635600	R5235600
EX635605	R5235605
EX635695	R5235695
EX635915	R5235915
EX636347	R5236347
EX636692	238989
EX636692	1844751C2
EX636692	1845150C92
EX636692	1846692C92
EX636692	4C3Z-9E527-AA
EX636977	R5236977
EX636978	R5236978
EX636980	R5236980
EX637045	R5237045
EX637099	R5237099
EX637466	R5237466
EX637557	3087557PX
EX637560	3087560PX
EX637635	R5237635
EX637650	R5237650
EX638489	1848489C91
EX727311	1847620C92
EXLVP2756	4746706
EXLVP2756	4638765
EXLVP2756	5019734AA
EXLVP2756	4897243AA
EXLVP2756	5011796AA
EXLVP2756	5011796AB
EXWP8182	1830606C94
FE0112-11B1	25163472
FE0114-11B1	25163473
FJ10039-11B1	17091432
FJ10058-11B1	17113221
FJ10109-11B1	F1TE-9F593-D1A
FJ10109-11B1	F1TE-9F593-D5A
FJ10202-11B1	E8TE-9F593-A
FJ10202-11B1	E8TE-9F593-B1C

Delphi	OEM
FJ10202-11B1	E8TE-9F593-A
FJ10484-11B1	17112202
FM1535	F6UU-10300-FA
FP10075-11B1	17113203
HAC101	8547194
HAC102	8547195
HAC103	8547236
HAC104	8547237
HAC105	8547543
HAC106	8547547
HAC107	8547548
HAC108	8547551
HAC109	8547552
HAC110	8547553
HAC111	8547561
HAC112	8547563
HAC113	8547577
HAC114	8547581
HAC115	8547626
HAC116	52450950
HAC117	52454595
HAC118	52458196
HAC119	52458839
HAC120	52461239
HAC121	52461240
HAC122	52461241
HAC123	52461242
HAC124	52461243
HAC125	52461246
HAC134	52470016
HDC900	22514724
HDC900	GPC101
HDC901	12015288
HDC902	22531535
HDC903	15575722
HDC903	GPC102
HDC904	12088520
HDC904	12182099
HDC904	12496078
HDC904	12052153
HDC904	AR145
HDC905	1803175C1
HDC905	E3TZ-9A444-A
HDC905	1803175C1
HDC905	GPC103
HDC906	1811059C91
HDC906	1811059C92
HDC906	GPC104
HDC906	F0TZ-12B533-A
HDC907	12088560
HDC907	12135176
HDC907	12496472
HDC907	GPC106
HDC908	1831646C1
HDC908	GPR111
HDC908	1826634C94
HDC908	F7TZ-12B533-A
HDC908	F7TZ-12B533-CA
HDC908	F81Z-12B533-AC

Delphi	OEM
HDC910	97226648
HDC910	8972266481
HDC911	97371491
HDC911	8972256082
HDC911	97225608
HDC912	1840903C91
HDC912	4C3Z-12B533-AA
HDS305	218464
HDS305	5613680
HDS305	1804211C2
HDS305	8G
HDS305	ZD1A
HDS306	9G
HDS306	1110
HDS307	218463
HDS307	5614220
HDS307	1807917C2
HDS307	1819649C1
HDS307	ZD9
HDS308	5613673
HDS308	5613826
HDS308	12G
HDS308	1109
HDS309	218465
HDS309	5613738
HDS309	25163212
HDS309	25168651
HDS309	11G
HDS310	1820697C2
HDS310	ZD11
HDS310	F4TZ-12A342-A
HDS310	1111
HDS800	5613939
HDS800	13G
HDS801	5614017
HDS801	15G
HDS802	97226202
HDS802	8972262022
HDS802	1113
HDS802	62G
HDS803	97251974
HDS803	8972519740
HDS805	1843286C2
HDS806	4C3Z-12A342-AA
HDS806	1117
HFP274	3904374
HFP274	4429374
HFP274	M73060
HFP274	5012376AA
HFP700	3917334
HFP700	3921550
HFP700	3925856
HFP700	3926034
HFP700	3930135
HFP700	3932225
HFP700	3933253
HFP700	3936317
HFP701	3284014
HFP701	3284073



Delphi OEM

HFP701	3284074
HFP701	3917997
HFP701	3917998
HFP701	3917999
HFP701	3918000
HFP701	3930201
HFP701	3930202
HFP701	3932226
HFP701	3933254
HFP701	3933255
HFP701	3936318
HFP701	3936319
HFP701	M73098
HFP701	4944712
HFP701	4988749
HFP702	3918076
HFP905	25115224
HFP905	P74001
HFP906	6442199
HFP906	M60281
HFP907	E3TZ-9350-B
HFP907	M60278
HFP909	25116503
HFP916	4761979
HFP916	M73104
HFP916	3925709
HFP916	3927153
HFP916	3930134
HFP916	3932224
HFP916	3933252
HFP916	3936316
HFP916	4988747
HFP916	5012209AA
HFP916	5012209AB
HFP917	1824415C91
HFP917	1824415C92
HFP917	1824415C93
HFP917	F6TZ-9350-A
HFP917	M61067
HFP917	F3UU-9K044-AA
HFP920	F81Z-9C407-AA
HFP920	F81Z-9C407-AC
HFP920	P74221
HFP921	25117340
HFP921	P74143
HFP922	15754298
HFP922	P74222
HFP923	4932707
HFP923	3938367
HFP923	3938435
HFP923	3990082
HFP923	3990105
HFP923	P74213
HFP923	5015553AA
HFP923	5080885AA
HFP923	5014228AA
HFP925	440008174
HFP926	440003178
HFP926	440003239

Delphi OEM

HFP927	440003228
HFP934	440008040
HFP937	440008086
HFP937	314G6227PS
HFP940	440008141
HFP941	9440080008
HFP942	9440080013
HFP943	4089602
HFP943	P76110
HFP943	5093135AA
HFP943	5093135AB
HFP943	5114434AA
HFP946	440008134
HFP948	9440080022
HFP948	E5HN-9350-AA
HFP953	15018546
HFP954	25121207
HFP955	15161174
HFP955	P74214
HTF100	1824982C91
HTF100	F4TZ-9C968-C
HTF100	F4TZ-9C968-CB
HTF100	2C3Z-9C968-BA
HTF101	1836412C91
HTF101	1841217C91
HTF101	F81Z-9C968-AA
HTF101	F81Z-9C968-AB
HTF102	97256734
HTF103	10159525
HTF104	25055457
HTF105	25055460
HTK100	1825806C92
HTK100	F6TZ-9C977-AN
HTK101	1826583C91
HTK102	691273C1
HTK103	1810491C1
HTK105	1807455C92
HTP104	F4TZ-9A543-BRM
HTP104	F5TZ-9A543-AA
HTP105	F6TZ-9A543-ARM
HTP107	F81Z-9A543-BRM
HTP108	F81Z-9A543-CRM
HTP109	1833564C92
HTP109	F8TZ-9229-AA
HTP110	7002371
HTP110	F4TZ-9D930-K
HTP114	1825681C95
HTP114	1842722C91
HTP116	1822326C92
HTP117	1822390C92
HTP119	F81Z-9D930-AB
HTP120	97209343
HTP120	8972093431
HTP122	3C3Z-9A543-AARM
HTP122	1882919C91
HTP123	4C3Z-9A543-AARM
HTP123	2591022C91
HTS100	CSS512
HTS100	F6TZ-12K073-A

Delphi OEM

HTS101	1876735C91
HTS101	CSS1103
HTS101	F7TZ-12K073-A
HTS101G	1876735C91
HTS101G	F7TZ-12K073-A
HTS102	F6TZ-9F838-A
HTS103	1812818C92
HTS103	F4TZ-9F838-A
HTS104	220215
HTS104	F4TZ-9J460-A
HTS105	F7TZ-9J460-BA
HTS105	4C3Z-9J460-A
HTS106	F5TZ-6C673-A
HTS107	97253673
HTS107	8972536730
HTS108	97224993
HTS109	25339321
HTS110	97261720
HTS110	97384931
HTS111	97225635
HTS112	227077
HTS112	9350899
HTS113	227074
HTS113	12215049
HTS114	25339320
HTS114	CSS9153
HTS115	97180655
HTS116	1807329C91
HTS116	1807329C92
HTS116	1807339C92
HTS117	1814320C1
HTS119	1997254
HTS120	1840078C1
HTS121	1807369C2
HTS123	1830669C91
HTS124	1697269C91
HTS125	1836537C91
HTS126	1835985C92
HTS126	8C3Z12K073-A
HTS127	1845428C91
HTS127	4C3Z-9F383-AB
HTS128	1836539C91
HTS128	3C3Z-12A697-AA
HTS129	1839415C91
HTS129	F81Z-9278-AA
HTS129	OP6222
HTS131	1839416C91
HTS132	1828345C91
HTS132	3C3Z-6C315-AA
HTS132	CSS9177
HTS133	12556263
HTS134	15684629
HTS135	15969349
HTS136	16131231
HTS137	25166816
HTS138	25174702
HTS139	25027400
HTS140	25028058
HTS142	25028874

Delphi OEM

HTS143	25029685
HTS144	25094453
HTS145	25094457
HTS146	25094460
HTS147	25094641
HTS148	25094663
HTS149	25164882
HTS150	25165356
HTS151	1845536C91
HTV102	5C3Z-9C968-CA
HTV103	1846296C91
HTV103	3C3Z-9F452-AC
HTV104	5C3Z-9F452-AA
HTV104	226690
HTV104	1846490C91
HTV105	226693
HTV105	1846491C91
HTV105	4C3Z-9F452-A
HTV106	10137639
HTV107	17112759
HTV108	1997258
HTV109	226461
HTV109	97288827
HTV110	1839437C95
HTV110	3C3Z-9C968-AA
L093PBB	433175062
L093PBB	114GC324AP4
L094PBA	114GC325
L094PBA	433175037
L101PBB	433175063
L101PBB	114GC324AP3
L102PBA	433175036
L102PBA	114GC325P3
L103PBA	433175096
L103PBA	114GC324AP6
L105PBA	114GC316
L105PBA	433171036
L106PBA	433171187
L106PBA	114GC318P9
L107PBA	433175014
L107PBA	114GC321P2
L108PBA	114GC319
L108PBA	433171058
L111PBA	114GC322
L111PBA	433171173
L112PBA	114GC323
L112PBA	433175020
L113PBA	433175089
L113PBA	114GC325P4
L114PBA	433175090
L114PBA	114GC325P6
L115PBB	433175064
L115PBB	114GC324AP5
L116PBA	114GC318
L116PBA	433171057
L116PBA	433171063
L116PBA	114GC318P2
L119SBA	114GC29
L119SBA	433270999

Delphi OEM

LJCK01101	F2TZ-9E527-A
LJCK01101	217619
LJCK01102	F3TZ-9E527-A
LJCK01102	217620
NLVP3450	641025
NLVP3450	97288505
NLVP3731	4C2Z2A451AA
NLVP3731	BRPV-1
NLVP4013	641300
NLVP4013	4429103
NLVP4342	641024
NLVP4342	F6TZ-2A451-AA
NLVP5041	641008
NLVP5041	F4TZ-2A451-A
PS10000-11B1	16187556
PS10000-11B1	16254539
PS10062-11B1	E7FZ-9F479-A
PS10074-11B1	12219931
PS10074-11B1	16006835
PS10075-11B1	21020103
PS10075-11B1	16017460
PS10075-11B1	16137039
PS10075-11B1	17112715
PS10075-11B1	161370390
RA1011-11B1	3096043
RA1021-11B1	52452179
RA1043-11B1	52457248
RA1046-11B1	52457549
RA1047-11B1	52457675
RA1050-11B1	52458537
RA1056-11B1	52460930
RA1088-11B1	52469619
RA1089-11B1	52469620
RA1090-11B1	52469621
RA1091-11B1	52469622
RA1092-11B1	52469623
RA1098-11B1	52470229
RA1111-11B1	52471174
RA1112-11B1	52471175
RA1113-11B1	52471180
RA1206-11B1	52487492
RA1207-11B1	52487493
RA20013-11B1	52470237
RM1004	1101293
RM1004	1101629
RM1004	10463110
RM1004	10463424
RM1004	10480094
RM1009	10463393
RM1009	10463417
RM1009	10480086
RM1009	10480097
RM1013	1101111
RM1013	1101633
RM1013	19013199
RM1013	19030013
RM1013	10463002
RM1013	10463339
RM1013	10479994

Delphi OEM

RM1013	10479997
RM1024	19030024
RM1024	10463940
RM1024	10480167
RM1036	10480130
RM1039	10480168
RM1055	10463425
RM1055	10480099
RM1360	19030329
RM1360	10480133
RM1385	10464438
RM1385	10480388W
RM1386	10464453
RM1507	D22F-10300-AA
RM1507	D22F-10300-AB
RM1507	D22F-10300-BB
RM1507	D2AF-10300-EA
RM1507	D2FZ-10346-B
RM1507	D20F-10346-B
RM1507	D32F-10300-AA
RM1507	D40F-10300-EA
RM1507	D40Z-10346-D
RM1507	D4ZF-10300-AA
RM1507	D52F-10300-BA
RM1507	E7PZ-10346-B
RM1507	D70F-10346-A
RM1507	D70F-10346-B
RM1507	D9VY-10346-C
RM1507	E7PF-10346-PA
RM1507	F0PU-10346-JA
RM1507	F0TU-10300-AA
RM1507	D50F-10300-CA
RM1507	D7EF-10300-AA
RM1507	D7EF-10300-BA
RM1507	D7EF-10300-CA
RM1507	D7EF-10300-DA
RM1507	D70F-10300-CA
RM1507	D70F-10300-EA
RM1507	D7ZF-10300-DA
RM1507	D8BF-10346-CA
RM1507	D8VF-10300-CA
RM1507	D8VF-10346-CA
RM1507	D9ZF-10300-BA
RM1507	E1AF-10300-DA
RM1507	E1BF-10300-BA
RM1507	E1BF-10346-CA
RM1507	E1ZF-10300-EA
RM1507	E37F-10300-AA
RM1507	E4LF-10300-CA
RM1507	E5LF-10300-AA
RM1507	E6DF-10300-CA
RM1507	E6DF-10300-FA
RM1507	E6DF-10300-FB
RM1507	E6DF-10300-HA
RM1507	D42F-10300-CA
RM1507	D20F-10300-AA
RM1507	D20F-10300-GA
RM1507	D20F-10346-BA
RM1507	D30F-10300-AA



Delphi OEM

RM1507	D40F-10346-DA
RM1507	D5DF-10300-AA
RM1507	D7ZF-10300-EA
RM1507	E1BZ-10346-A
RM1507	E6DZ-10346-D
RM1507	E9TF-10300-AA
RM1507	D50F-10300-AA
RM1507	D7DF-10300-AA
RM1507	D70F-10300-AA
RM1507	D70F-10300-DA
RM1507	D70F-10346-AA
RM1507	D70F-10346-BA
RM1507	D7UF-10300-AA
RM1507	D8BF-10300-DA
RM1507	D8BF-10346-DA
RM1507	E1TF-10300-BA
RM1507	E3TF-10300-AB
RM1507	E3ZF-10300-AA
RM1507	E5ZF-10300-AA
RM1507	D9BF-10346-C
RM1507	D9DF-10300-AA
RM1507	D9TF-10300-AA
RM1507	D9UF-10300-EA
RM1507	D8ZF-10300-FA
RM1507	D9AF-10300-CA
RM1507	D90F-10300-AA
RM1508	D22F-10346-BB
RM1508	D3VF-10300-AA
RM1508	D3VF-10300-AB
RM1508	D3VF-10300-BA
RM1508	D3VF-10346-BA
RM1508	D4TF-10300-DA
RM1508	E7TF-10300-JA
RM1508	E7TF-10300-NA
RM1508	F0LU-10300-AA
RM1508	F0PU-10346-KA
RM1508	D7UF-10300-CA
RM1508	D7VF-10346-AA
RM1508	D7ZF-10300-BA
RM1508	D7ZF-10300-CA
RM1508	D8VF-10300-BA
RM1508	E1AF-10300-BA
RM1508	E1NF-10300-AA
RM1508	E1UF-10300-AA
RM1508	E3UF-10300-AB
RM1508	E6DF-10346-DA
RM1508	E7DF-10300-FA
RM1508	D4TZ-10346-A
RM1508	E7TF-10300-GA
RM1508	F0AU-10300-AA
RM1508	F0UU-10300-BA
RM1508	D50F-10300-BA
RM1508	D5UF-10300-AA
RM1508	D6UF-10300-AA
RM1508	D7UF-10300-BA
RM1508	D9UF-10300-FA
RM1509	E7PZ-10346-A
RM1509	F0PZ-10346-C
RM1509	D7VZ-10346-A

Delphi OEM

RM1509	E7VF-10300-AA
RM1509	E7VF-10300-BA
RM1509	D5ZF-10300-BA
RM1509	D8VF-10346-BA
RM1509	E1BF-10300-CA
RM1509	E1VF-10346-AA
RM1509	E1VZ-10346-A
RM1509	E5VF-10300-AA
RM1509	D9VY-10346-D
RM1509	E7PF-10346-RA
RM1509	D70F-10300-BA
RM1509	E7DF-10300-EB
RM1509	D9UF-10300-GA
RM1509	D9BF-10300-AA
RM1509	D3VY-10346-A
RM1509	F0PZ-10346-D
RM1520	E7PZ-10346-E
RM1520	E8PF-10346-A
RM1520	E7PF-10346-UA
RM1520	E7SF-10300-FA
RM1520	E8PF-10300-BA
RM1520	E8PF-10346-AA
RM1520	E63F-10300-AA
RM1520	E6AF-10300-AA
RM1520	E6AF-10300-AF
RM1520	E6AF-10300-BA
RM1520	E6SF-10300-AA
RM1520	E6SF-10300-BA
RM1520	E6TF-10300-CA
RM1520	E6TZ-10346-A
RM1520	E6UF-10300-AA
RM1520	E6ZF-10300-CA
RM1520	E6ZF-10346-B
RM1520	E7AF-10300-BA
RM1520	E7AF-10300-CA
RM1520	E7AF-10300-DA
RM1520	E7PZ-10346-L
RM1520	E7SF-10300-KA
RM1520	E7ZF-10300-DA
RM1520	E6TF-10300-BA
RM1520	E6TF-10346-AA
RM1520	E6ZF-10346-BA
RM1520	E7PZ-10346-E
RM1520	E7PZ-10346-L
RM1520	E7SF-10300-FA
RM1520	E6SF-10300-AA
RM1520	E6SF-10300-BA
RM1520	E6TF-10300-BA
RM1520	E6TF-10346-AA
RM1520	E6ZF-10346-BA
RM1520	E7AF-10300-CA
RM1520	E7PF-10300-GA
RM1520	E7PF-10346-UA
RM1520	E7SF-10300-KA
RM1520	E7ZF-10300-DA
RM1520	E8PF-10300-BA
RM1520	E8PF-10346-AA

Delphi OEM

RM1520	E6TZ-10346-A
RM1520	E6ZZ-10346-B
RM1520	E8PZ-10346-A
RM1520	E6TF-10300-CA
RM1520	E6UF-10300-AA
RM1520	E6ZF-10300-CA
RM1520	E7AF-10300-BA
RM1520	E7AF-10300-DA
RM1520	E63F-10300-AA
RM1520	E6AF-10300-AA
RM1520	E6AF-10300-AF
RM1520	E6AF-10300-BA
RM1535	F2TU-10300-AF
RM1535	F37U-10300-AA
RM1535	F3UZ-10346-A
RM1535	F3UU-10300-AE
RM1535	F3UU-10300-AF
RM1535	F6UU-10300-CA
RM1535	F6UU-10300-EA
RM1535	F6UU-10300-CA
RM1535	F81Z-10346-EA
RM1563	F81U-10300-EB
RM1563	F81Z-10346-EA
RM1563	F81U-10300-EB
RM1564	F81U-10300-GA
RM1564	F81U-10300-GA
RM1564	F81Z-10346-GA
RM1588	E7PF-10346-LA
RM1588	E9PF-10346-FA
RM1588	E9PF-10346-FA
RM1588	E7PF-10346-LA
RM1595	F0TU-10300-BA
RM1595	F0TU-10300-BA
RM1596	E9UF-10300-AA
RM1596	F0UU-10300-AA
RM1596	F0UU-10300-AA
RM1596	E9UF-10300-AA
RM1601	5233160
RM1601	5233199
RM20000	10459027
RM20001	10459028
RM20002	10459047
RM20003	10459233
RM20004	10459256
RM20005	10463210
RM20006	10463300
RM20007	10463529
RM20008	10465160

Delphi OEM

RM3749	F5UU-10300-CA
RM3749	F5UZ-10346-CA
RM3749	F5UZ-10346-CA
RM3749	F5UU-10300-CA
RM3979	5233608
RM3979	5233660
RM4011	5233733
RM4011	5234033
SS10125-11B1	10456607
SS10126-11B1	12557046
SS10128-11B1	56027871
SS10177-11B1	56027272
SS10178-11B1	56027273
SS10382-11B1	17123852
SS10387-11B1	F4SZ-9B989-A
SS10387-11B1	F4SZ-9B989-A
SS10423	E8FZ-9B989-A
SS10423	E8FZ-9B989-A
SS10425-11B1	17106681
SS10428-11B1	E7TZ-9B989-A
SS10428-11B1	E7TZ-9B989-A
SS10441-11B1	5234902
SS10449-11B1	F2AZ-9B989-A
SS10449-11B1	F2AZ-9B989-A
SS10450-11B1	F2TZ-93989-B
SS10450-11B1	F2TZ-93989-B
SX1103	E3TZ-11002-B
SX1103	E3TF-11000-AA
SX1103	E3TF-11000-AA
SX1103	E3TZ-11002-B
SX1104	1113267
SX1104	1113270
SX1104	1113296
SX1104	10465054
SX1104	10465014
SX1124	1113266
SX1124	1113269
SX1124	1113295
SX1124	10465053
SX1124	10465013
SX20000	10461081
SX20001	10461082
SX20002	10465167
SX20003	10465320
SX20004	10465321
SX20005	10465322
SX20006	10465375
SX3456	E8TZ-11002-A
SX3456	E5TZ-11002-B
SX3456	F3TU-11000-AA

Delphi OEM

SX3456	E8TF-11000-AA
SX3456	E5TF-11000-AA
SX3456	E5TF-11000-AA
SX3456	E8TF-11000-AA
SX3456	F3TU-11000-AA
SX3456	E5TZ-11002-B
SX3456	E8TZ-11002-A
SX3461	F4TZ-11002A
SX3461	F5TU-11000-AA
SX3461	F5TU-11000-AB
SX3461	F5TU-11000-AA
SX3461	F5TU-11000-AB
SX3461	F4TZ-11002A
SX3467	1C3Z-11002AA
SX3467	1C3Z-11002AA
SX3468	1C2Z-11002AA
SX3468	XW4U-10300-CE
SX3468	XW4Z-10346-CC
SX3468	XW4U-10300-CC
SX3468	XW4U-10300-CC
SX3468	XW4U-10300-CE
SX3468	XW4Z-10346-CC
SX3468	XW4U-10300-CD
SX3468	1C2Z-11002AA
SX3469	97209548
SX3496	F4TZ-11002-B
SX3496	F4PU-11000-AA
SX3496	F4TZ-11002-B
SX3496	F4PU-11000-AA
SX3691	3921682
SX3691	4428221
SX3717	4741012
SX3717	4793110
TS10001-11B1	E1AZ-12A648-A
TS10001-11B1	F2AZ-12A648-A
TS10001-11B1	F2AZ-12A648-A
TS10001-11B1	E1AZ-12A648-A
TS10019-11B1	5226374
TS10019-11B1	33004281
TS10023-11B1	F5AZ-12A697-A
TS10023-11B1	F5AZ-12A697-A
TS10031	56004815
TS10032-11B1	10096181
TS10034	4111482
TS10072-11B1	12160244
TS10075-11B1	12146312
TS10075-11B1	15326386
TS10078-11B1	25037332
TS10090-11B1	25037334

Delphi OEM

TS10098-11B1	F6SZ-12A697-A
TS10098-11B1	F6SZ-12A697-A
TS10131-11B1	4720314
TS10133-11B1	4720315
TS10135-11B1	5011852AA
TS10135-11B1	5011852AA
TS10138-11B1	8993146
TS10197-11B1	4638643
TS10201-11B1	F3VY-12A647-A
TS10201-11B1	F3VY-12A647-A
WP4913	12456231
WP4913	44056
WP4925	12534772
WP4925	44042
WP4937	15633466
WP4937	23500138
WP4937	44100
WP5885	F81Z-8501-ARM
WP5885	F7TZ-8501-BRM
WP5885	F7TZ-8501-CRM
WP5885	F81Z-8501-CRM
WP5885	F6TZ-8501-AA
WP5885	45000
WP5903	F81Z-8501-BRM
WP5903	F4TZ-8501-A
WP5903	F4TZ-8501-ARM
WP5903	F5TZ-8501-BRM
WP5903	F5TZ-8501-CRM
WP5903	45007
WP7123	3802004
WP7123	4429404
WP7123	41181
WP8550	12514269
WP8550	14050546
WP8550	44099
WP8553	12532528
WP8585	E9TZ-8501-B
WP8585	E3TZ-8501-D
WP8585	E4TZ-8501-C
WP8585	44018
WP8721	97216136
WP8721	42349

NOTE: Interchange by using a competitor part number is not positive identification. Certain competitor part number interchanges are included at popular request, but absolute correlation is not possible. No responsibility is assumed by manufacturer or publisher for consequential or other damages which may arise from reliance on a competitor part number to make identification.

DISCLAIMER OF WARRANTY – The information contained herein has been obtained from reliable sources and is accurate insofar as is ascertainable. However, no warranty is either expressed or implied as to the accuracy of this catalog and no responsibility is assumed by the publisher for any damages. The acceptance of this catalog is conditional to the acceptance of this disclaimer of warranty.



ELECTRONIC UNIT INJECTORS FOR DDC SERIES 60 ENGINES

CROSS-REFERENCE CARD

Detroit Diesel Reference Number	Delphi Part Number	DDEC	Engine Size	Engine Model Years	HP	RPM
R5234785	EX634785	II	12.7L	1988-1989	350-400	1800-2100
R5234795	EX634795	II	12.7L	1988-1989	350-425	1800-2100
R5234865	EX634865	II	11.0L	1989-1990	N/A	N/A
R5234870	EX634870	II	11.0L	1988-1989	250-365	1800-2100
R5234935	EX634935	II/III	11.0L	1990-1993	250-365	1800-2100
R5234940	EX634940	II/III	12.7L	1990-1993	355-425	1800-2100
R5234945	EX634945	II	12.7L	1990	425-450	1800-2100
R5234970	EX634970	II/III	12.7L	1990-1993	425-450	1800-2100
R5235550	EX635550	III	11.1L	1994-1998	N/A	N/A
R5235575	EX635575	III	12.7L	1994-1998	360-430	1800-2100
R5235580	EX635580	III	11.1L	1994-1998	300-350	1800-2100
R5235600	EX635600	III	12.7L	1994-1998	360-430	1800-2100
R5235605	EX635605	III	11.1L	1994-1998	300-350	1800-2100
R5235695	EX635695	III	12.7L	1994-1998	360-430	1800-2100
R5235915	EX635915	III	12.7L	1994-1998	470-500	1800-2100
R5236347	EX636347		8.5L			
R5236977	EX636977	IV	12.7L	1999-2002	365-430	1800-2100
R5236978	EX636978	IV	11.1L	1998-2002	300-350	1800-2100
R5236980	EX636980		8.5L			
R5236981	EX636981		8.5L			
R5237045	EX637045	IV	12.7L	1999-2002	365-430	1800-2100
R5237099	EX637099		12.7L			
R5237466	EX637466	IV	12.7L	1998-1999	435-500	1800-2100
R5237635	EX637635	IV	14.0L	1999-2002	455-515	1800-2100
R5237650	EX637650	IV	12.7L	1999-2002	435-500	1800-2100

REMANUFACTURED CUMMINS CELECT ELECTRONIC INJECTORS

CROSS-REFERENCE CARD

Delphi Part Number	Cummins Part Number	Engine Model
EX631753	3411753PX	M11 330
EX631756	3411756PX	M11 ISM 335
EX631758	3411758PX	M11
EX631760	3411760PX	N14, 435E – 500E – 350ESP – 410E
EX631761	3411761PX	N14 – 310E – 370E
EX631763	3411763PX	N14 – 425E – 525E
EX631764	3411764PX	N14 - 525CE
EX631766	3411766PX	N14
EX631767	3411767PX	N14A – 14E
EX632542	3652542PX	N14, 430E – 350E – 460E
EX637557	3087557PX	M11, 280E – 330E – M11 ESP 11, 350E, 370E, 400E
EX637560	3087560PX	N14, 310P, 330P

Delphi Part	Cummins Parts Listing (CPL)														
EX631753	2036	2037	2370	2371	2178										
EX631756	2199	2200	2477	2350	2610	2607	2608	2828	2614	2612	2607	2611	2615	2576	2589
EX631758	2425	2201													
EX631760	1809	1844	1987	2026	1896	1897	2492	1852	2306						
EX631761	2027	2389	2590												
EX631764	2403	2143	2228	2261	1924	9921	9925	9951	2659	2809					
EX631763	2025	2003													
EX631766	2390	2398	2591												
EX631767	2391	2592													
EX632542	1572	1573	1574	1575	1580	1649	1831	1944	1583						
EX637557	1828	1829	1830	1841	1855	1856	1857	2097	1875	1973	1885	1827	2097		
EX637560	1807														

EUI Injectors – Volvo and Detroit Diesel Series 50 & Series 60

The **CORE RETURN POLICY** for the Delphi Exchange Electronic Unit Injector program is as follows:

- All Volvo Electronic Unit Injector (EUI) cores returned must be exact replacements for units ordered. Cores will not be accepted if they do not match replacement units.
- For Series 50 & Series 60 cores please reference below:

GROUP CLASSIFICATION OF CORES:

Group 1 - EX634785, EX634795, EX634865, EX634870, EX634935, EX634940, EX634945, EX634970

Group 2 - EX635550, EX635575, EX635580, EX635600, EX635605, EX635695, EX635915, EX636347, EX637466, EX637650

Group 3 - EX636977, EX636978, EX636980, EX636981, EX637045, EX637099, EX637466, EX637635, EX637650

Cores will be accepted for any of the exchange injectors within the specific group classification. Example: if you purchased EX634795 you can return any of the part numbers listed in Group 1 ONLY.

- Units must be properly identified with their part number
- All acceptable cores must be intact and not damaged
- Fire damaged injectors will not be accepted
- Unacceptable cores will be scrapped immediately
- Core and warranty units not returned in the original box will receive no credit
- Cores must be returned within 12 months from the date of purchase

SEIZED CORES ARE NOT ACCEPTABLE

Distance from the top of the follower to the spring base must be:

A: SERIES 50/60

LP, HP
3.125"

LS
3.500"

VOLVO

V, W
2.68"

Y
2.63"

WARRANTY POLICY

One year warranty, unlimited mileage/hours on all products. Refer to the Delphi Diesel Aftermarket website: <http://dieselaftermarket.delphi.com> R&R will be considered on Series 50 & 60 EUI. Contact your Delphi sales representative for details. Incidental or consequential damages will not be considered.

EUI Injectors – Delphi Remanufactured Cummins Celect Injectors

CORE RETURNS must meet the following criteria:

- Units must be properly identified with their part number.
- Units must be returned as off of the engine-assembled and complete.
- Units damaged by fire will not be accepted.

GROUP CLASSIFICATION OF CORES:

	DELPHI PART NUMBERS	INTERCHANGE NUMBERS
Group 1	EX632542	365242, 3073995, 3081315
Group 2	EX631753, EX637557, EX631756, EX631758	3087557, 3411752, 3084589, 3411753, 3095040, 3087734, 3609922, 3166395
Group 3	EX631763, EX631761, EX637560, EX631760, EX631767, EX631766, EX631764	3087560, 3087733, 3083846, 3411759, 3411767, 3411385, 3411760, 3087558, 3083848, 3087807, 3411761, 3411765, 3411381, 3609796, 3411763, 3095086, 3087788, 3411762, 3087556, 3411766, 3409975, 3411691, 3088178, 3096662, 3408300, 3408303, 3084473

Cores will be accepted for any of the exchange injectors within the specific group classification. Example: if you purchased EX631763 you can return any of the part numbers listed in group 3 ONLY.

Important Note: Cores must be returned within 12 months from the date of purchase. Unacceptable cores not meeting the above criteria will be scrapped and no credit will be issued

WARRANTY POLICY

These injectors are warranted to be free from defects in materials or workmanship as follows:

- 2 years or 125,000 miles for on highway applications from date of sale to the end user.
- 2 years or 3,600 hours for off highway applications from date of sale to the end user.

All other warranty policies apply; refer to section eight of the procedure manual. R&R will be considered on Cummins Celect EUI. Contact your Delphi sales representative for details. Incidental or consequential damages will not be considered.

High-Pressure Oil Pumps

In order to receive warranty and/or core credit, the units must meet the following criteria:

1. Model year for model year.
2. No prior disassembly.
3. No missing components.
4. No external damage (damage due to fire).
5. Units must be returned within one (1) year.
6. Units must be returned with connection fittings.
7. Core and warranty units not returned in the original box will receive no credit.

Units not meeting the above criteria will receive no core credit and will be scrapped.



Starters and Alternators

In order to receive warranty and/or core credit, the units must meet the following criteria:

1. Core and warranty units not returned in the original box will receive no credit.
2. Disassembled or damaged warranty units will receive full core credit only.
3. Disassembled or un-rebuildable cores will receive no core credit.
4. Damaged cores will receive 50% core credit only.

Units not meeting the above criteria will receive no core credit and will be scrapped.

Water Pumps SRA, Reman Vacuum Pump & ECM/PCM/ECU

In order to receive warranty and/or core credit, the units must meet the following criteria:

1. Core and warranty units not returned in the original box will receive no credit.
2. Disassembled or damaged warranty units will receive full core credit only.
3. Disassembled or un-rebuildable cores will receive no core credit.

Units not meeting the above criteria will receive no core credit and will be scrapped.

WARRANTY POLICY

One year warranty, unlimited mileage/hours on all products with the exception of:

- EGR valves: 3000 miles/4828 km or 90 days from the date of installation
- ECM/PCM/ECU: 90 days from the date of installation
- Vacuum pump #EXLVP2756: 1 year or 18,000 miles

Refer to the Delphi Diesel Aftermarket website; <http://dieselaftermarket.delphi.com>, for additional warranty information.

No R & R and/or contingent liability warranty.

RADIATOR DIMENSIONS

Delphi Part	Core Dimension	Engine Oil Connection	Trans Oil Connection	Heater Return	Miscellaneous Information
RA1011-11B1	698.4 x 646.4 x 34mm	3/4" fitting	none	Y	
RA1021-11B1	798.1 x 646.8 x 55mm	none	3/4" fitting	Y	
RA1043-11B1	798.1 x 646.8 x 34mm	3/4" fitting	3/4" fitting	Y	
RA1046-11B1	897.3 x 646.8 x 34mm	none	3/4" fitting	Y	
RA1047-11B1	798.1 x 646.8 x 34mm	3/4" fitting	3/4" fitting	Y	W/Low Coolant Sensor
RA1050-11B1	798.1 x 591.8 x 34mm	none	3/4" fitting	Y	W/Low Coolant Sensor
RA1056-11B1	798.1 x 646.8 x 34mm	3/4" fitting	3/4" fitting	Y	W/Low Coolant Sensor
RA1088-11B1	798.1 x 646.8 x 34mm	3/4" fitting	1' 1/16" fitting	Y	
RA1089-11B1	798.1 x 646.8 x 34mm	none	1' 1/16" fitting	Y	
RA1090-11B1	897.3 x 646.8 x 34mm	none	1 1/16 fitting	Y	
RA1091-11B1	798.1 x 591.8 x 34mm	none	3/8" x 16	Y	
RA1092-11B1	798.1 x 591.8 x 34mm	none	1' 1/16" fitting	Y	W/Low Coolant Sensor
RA1098-11B1	774.1 x 592 x 34mm	none	3/8" x 16	Y	
RA1112-11B1	798.1 x 591.8 x 34mm	none	1' 1/16" O-ring fitting	N	
RA1113-11B1	798.1 x 591.8 x 34mm	1' 1/16" fitting	3/4" fitting	N	W/Low Coolant Sensor
RA1206-11B1	798.1 x 591.8 x 34mm	5/8" Quick connect	none	N	W/Low Coolant Sensor
RA1207-11B1	798.1 x 591.8 x 34mm	1' 1/16" fitting	5/8" Quick connect	N	W/Low Coolant Sensor
RA20013-11B1	774.7 x 596.9 x 54mm	none	none	N	





Available from:



Delphi Diesel Aftermarket, 1624 Meijer Drive, Troy, MI 48084, USA
<http://Dieselaftermarket.delphi.com>
E-mail: ddana@delphi.com
Publication No. DDSU501E-2 © 2009 Delphi Technologies, Inc
All Rights Reserved

Delphi
Diesel Commercial Vehicle
February 2009
First Printing
Litho in U.S.A.
Program Catalog



DDSU501E-2